

**SMYRNA SCHOOL DISTRICT
Clayton Elementary School Renovations
Bid Number SSD-16-001-CES**

ADDENDUM NO. 2

04 May 2016

Smyrna School District
Thomas D. Clayton Building
80 Monrovia Ave.
Smyrna, Delaware 19977

Fearn-Clendaniel Architects, Inc.
6 Larch Avenue Suite 398
Wilmington, Delaware, 19804
Phone: (302) 998-7615

BIDS DUE:

3:00 p.m. on May 17, 2016

LOCATION:

**Smyrna School District Administrative Offices
82 Monrovia Ave, Smyrna, DE 19977**

ARCHITECT'S PROJECT NO: 14107c

1.0 NOTICE TO ALL BIDDERS:

- 1.1. Bidders are hereby notified that this Addendum shall be and hereby becomes part of their Contract Documents, and shall be attached to the Project Manual for this project.
- 1.2. The following items are intended to revise and clarify the Contract Documents, and shall be included by the Bidder in their proposal.
- 1.3. Bidders shall verify that their sub-bidders are in full receipt of the information contained herein.
- 1.4. A lighting substitution was submitted. The results will be included in the next Addendum.

2.0 CHANGES TO THE DRAWINGS:

- 2.1. Site Plan, 1 of 1: Replace with revised drawing issued in this Addendum. The drawing has been revised to indicate an 8" Fire Service line run from the New Fire Pump room addition to the adjacent existing 8" water service. See items clouded on the drawing.
- 2.2. Drawing E11-01: In all corridors, replace existing 20A toggle switches and coverplates with barrel style key switches. Contractor to field verify single pole, 3 way or 4 way. Include costs for up to 12 switches.
- 2.3. Drawing E11-02: Cafeteria Room 27: There are three (3) single pole, 20A slot style key switches that operate the three (3) rows of lights in this room. Replace existing switches with barrel style key switches and three (3) gang coverplate.
- 2.4. Drawing E11-02: Gymnasium Room 28: There are three (3) single pole, 20A slot style key switches that operate the three (3) rows of lights in this room. Replace existing switches with barrel style key switches and three (3) gang coverplate.

- 2.5. Drawing E11-02: In all corridors, replace existing 20A toggle switches and coverplates with barrel style key switches. Contractor to field verify single pole, 3 way or 4 way. Include costs for up to 12 switches.

END OF ADDENDUM NO. 2

SITE DATA

1. PURPOSE OF THIS PLAN: TO DOCUMENT THE EXISTING CONDITIONS OF THE SITE.
2. OWNER ADDRESS: SMYRNA SPECIAL SCHOOL DISTRICT
22 SOUTH MAIN STREET
SMYRNA, DE 19777
3. PROPERTY ADDRESS: 510 MAIN STREET
CLAYTON, DE 19938
4. TAX PARCEL NUMBERS: 3-04-018.11-01-49.00-000
5. AREA OF PARCEL: 12.144 ACRES
6. ZONINGS: R - RESIDENTIAL 1-FAMILY AND TOWNHOUSE DISTRICT
- | LOT AREA | LOT WIDTH | STREET YARD | SIDE YARD | REAR YARD | PAVING STREET / OTHER YARD | BUILDING HEIGHT |
|----------|-----------|-------------|-----------|-----------|----------------------------|-----------------|
| N/A | 50' | 20' | 10' | 10' | N/A | 35' |
8. SOURCE OF TITLE: DEED INSTRUMENT NO.: 20150917-0047632
9. DATUM: VERTICAL - NAVD 88
HORIZONTAL - DELAWARE STATE PLANE NAD 83
10. DATE OF SURVEY: NOVEMBER 2015 BY CDA ENGINEERING, INC.

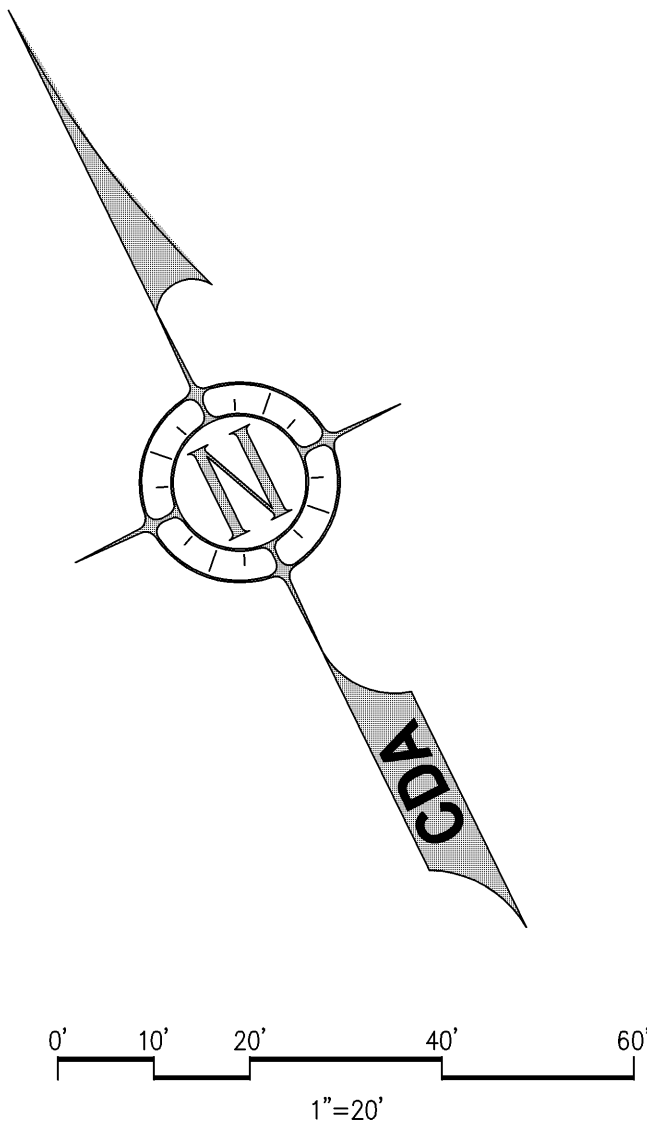
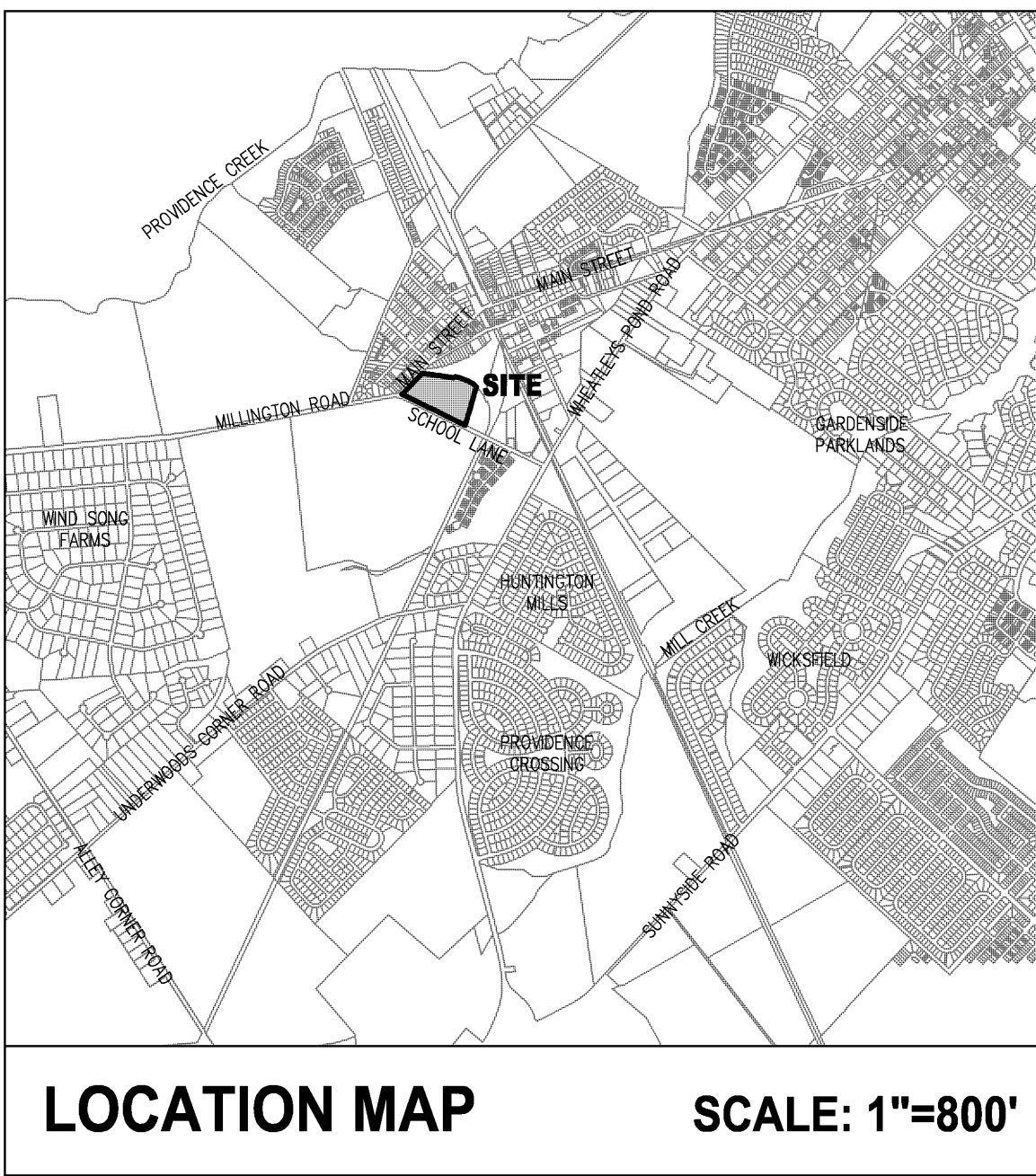
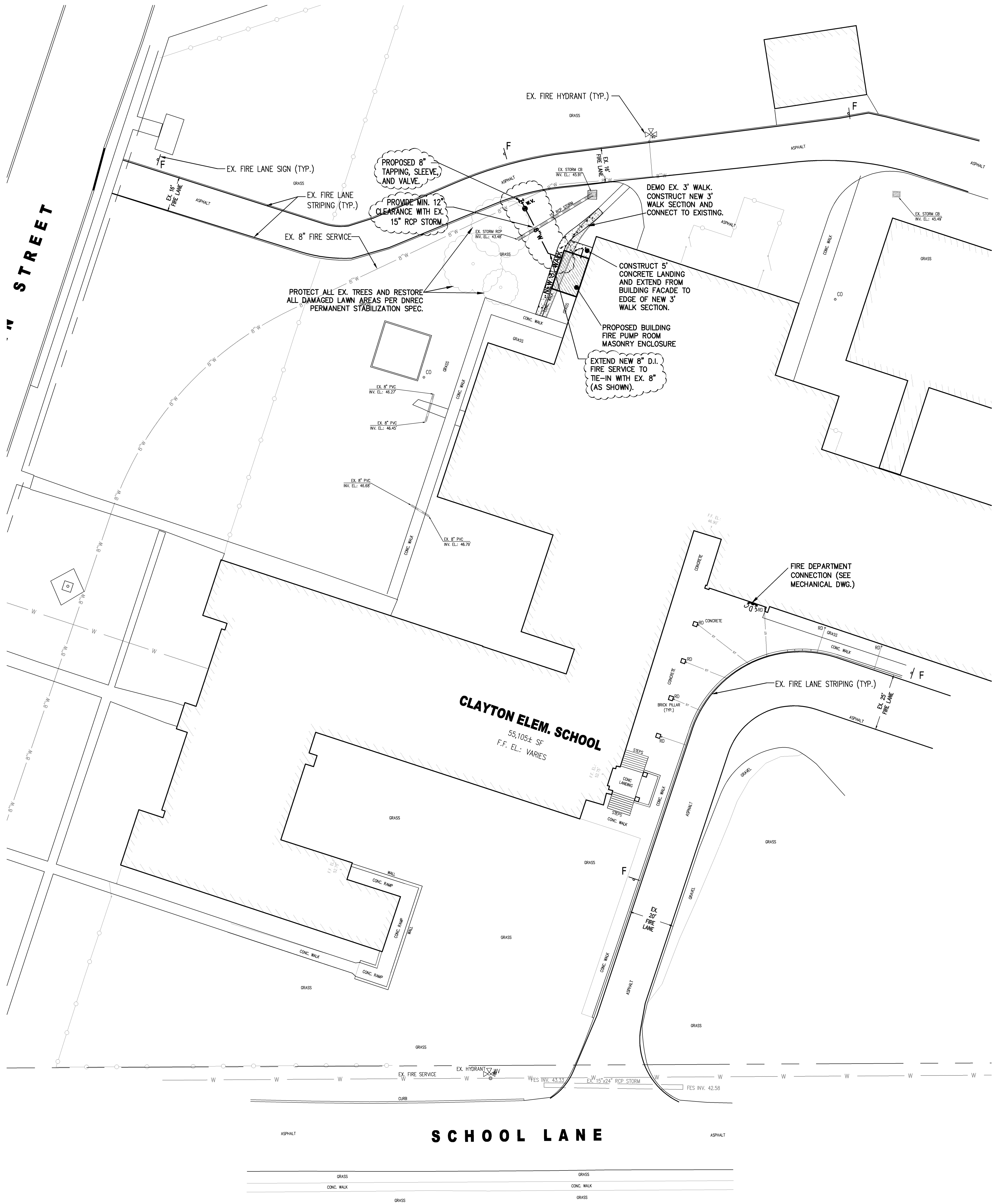

- CIVIL ENGINEER**
CDA ENGINEERING, INC.
6 LARCH AVE., SUITE 401
WILMINGTON, DE 19804
P: 302-998-9202 F: 302-691-1314
- STRUCTURAL ENGINEER**
BAKER, INGRAM & ASSOCIATES
1050 S. STATE STREET
DOVER, DE 19901
P: 302-734-7400 F: 302-734-7592
- MECHANICAL/PLUMBING ENGINEER**
DEDC
315 S. CHAPEL STREET
NEWARK, DE 19711
P: 302-738-7172 F: 302-738-7175
- ELECTRICAL ENGINEER**
FAYDA ENGINEERING & ES, LLC
801 W. NEWPORT PIKE
WILMINGTON, DE 19804
P: 302-999-1060 F: 302-999-1053

THIS DRAWING AND THE DESIGN FEATURES REPRESENTED ARE PROPRIETARY TO FEARN-CLENDANIEL ARCHITECTS, INC. AND SHALL NOT BE REPRODUCED, ALTERED OR COPIED WITHOUT WRITTEN PERMISSION.
© FEARN-CLENDANIEL ARCHITECTS, INC.

ISSUE DATES:
- ISSUED FOR BIDDING/CONSTRUCTION 4-19-2016
- ADDENDUM NO. 2 5-04-2016

Fearn Clendaniel
Architects
INC.
6 Larch Avenue • Suite 398 • Wilmington, Delaware 19804
Ph. 302-998-7815 • Fax. 302-998-7885
www.fearnclendaniel.com

PROJECT
CLAYTON ELEMENTARY SCHOOL
ADDITION AND RENOVATIONS
510 Main Street
Clayton, DE 19938
SEDIMENT AND STORMWATER MANAGEMENT PLANS
DRAWING TITLE:
SITE CONSTRUCTION PLAN
DWN BY: ZK CD PROJ. NUMBER:
DATE: 01-12-2016 DRAWING NUMBER:
SCALE: 1 of 1