

LEGEND:



1.5" MILL AND OVERLAY



PARTIAL-DEPTH REPLACEMENT

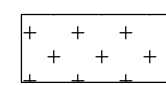

FULL-DEPTH REPLACEMENT



CRACK SEALING AND SEAL COAT

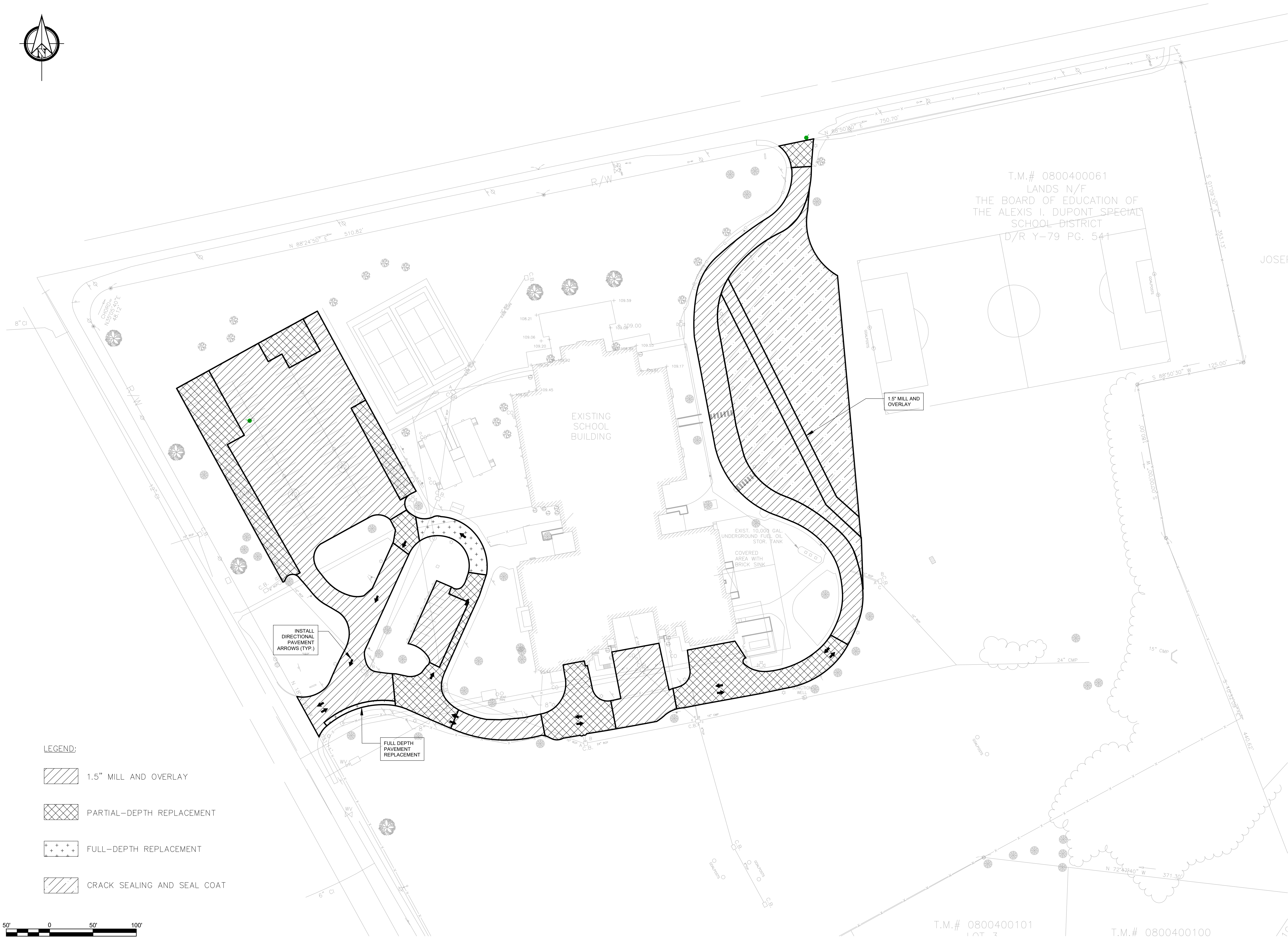

T.M.# 0800400061
LANDS N/F
THE BOARD OF EDUCATION OF
THE ALEXIS I. DUPONT SPECIAL
SCHOOL DISTRICT
D/R Y-79 PG. 541

JOSEI

SITE PLAN

PAVEMENT IMPROVEMENTS

H.B. DUPONT MIDDLE SCHOOL

735 MEETING HOUSE ROAD

HOCKESSIN ~NEW CASTLE COUNTY ~ DELAWARE

OWNER: RED CLAY CONSOLIDATED
SCHOOL DISTRICT
1502 SPRUCE AVENUE
WILMINGTON, DE 19805
PHONE: (602) 552-5100

REVISION	CHK BY	DATE	DESIGNED BY:	CHECKED BY:
No.			MBV	MBV
			FILE NAME:	
			APC	12571.GB+PAVE



5400 LIMESTONE ROAD
WILMINGTON, DE 19808-1232
TEL: 302.239.6634
FAX: 302.239.8485

OFFICES IN DELAWARE, MARYLAND,
PENNSYLVANIA AND NEW JERSEY
WEB: HTTP://DUFFNET.COM
E-MAIL: DUFFIELD@DUFFNET.COM

DATE: 4 MAY 2020
SCALE: 1" = 50'
PROJECT NO. 12571.GB
SHEET: 1 OF 2

T.M.# 0800400101
LOT 2

T.M.# 0800400100

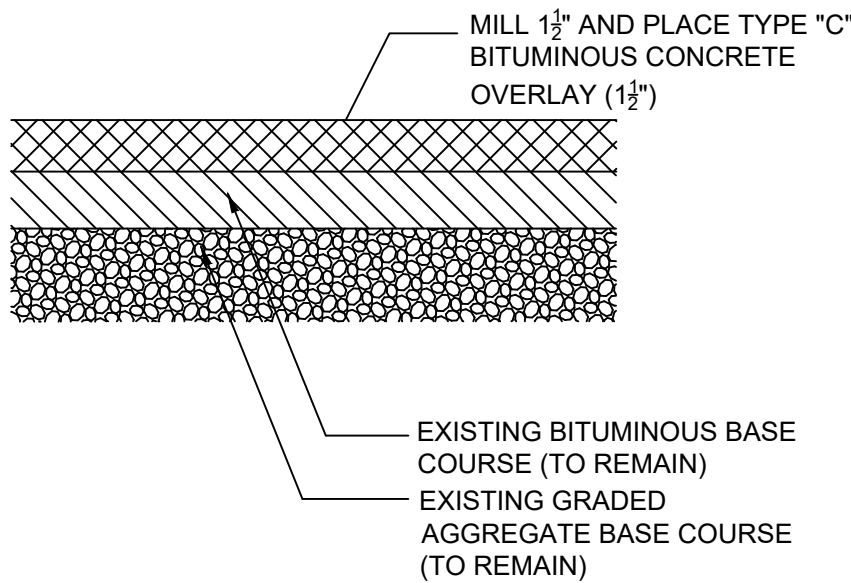

DETAIL: 1 1/2" MILL AND OVERLAY
SCALE: NO SCALE

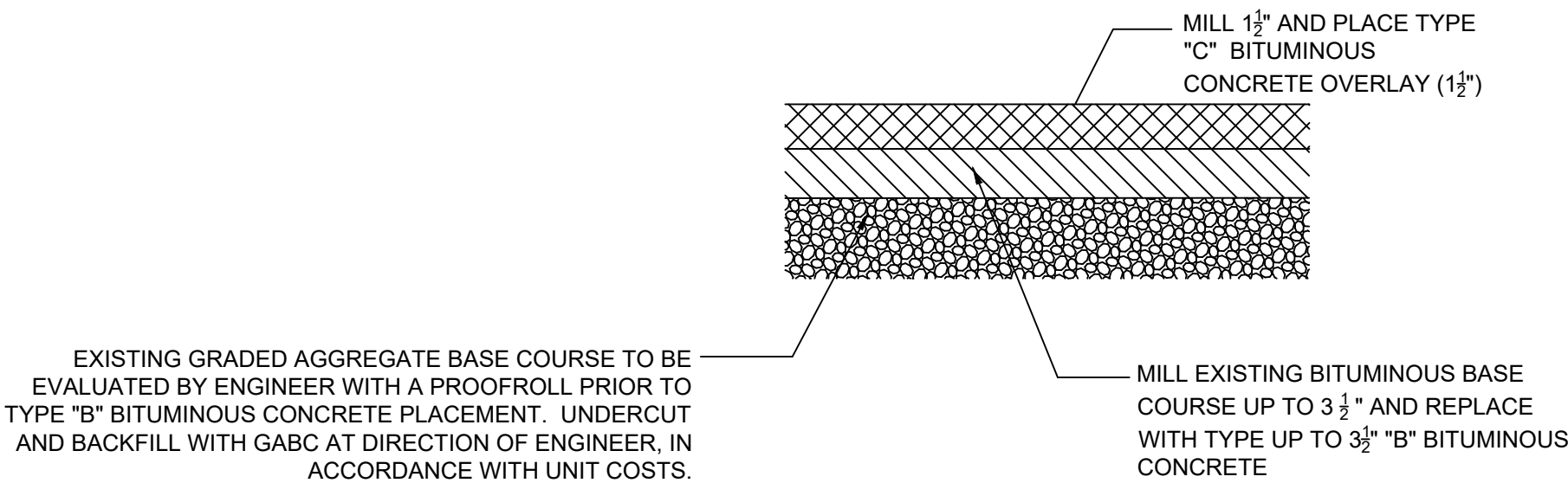

DETAIL: PARTIAL-DEPTH REPLACEMENT
SCALE: NO SCALE

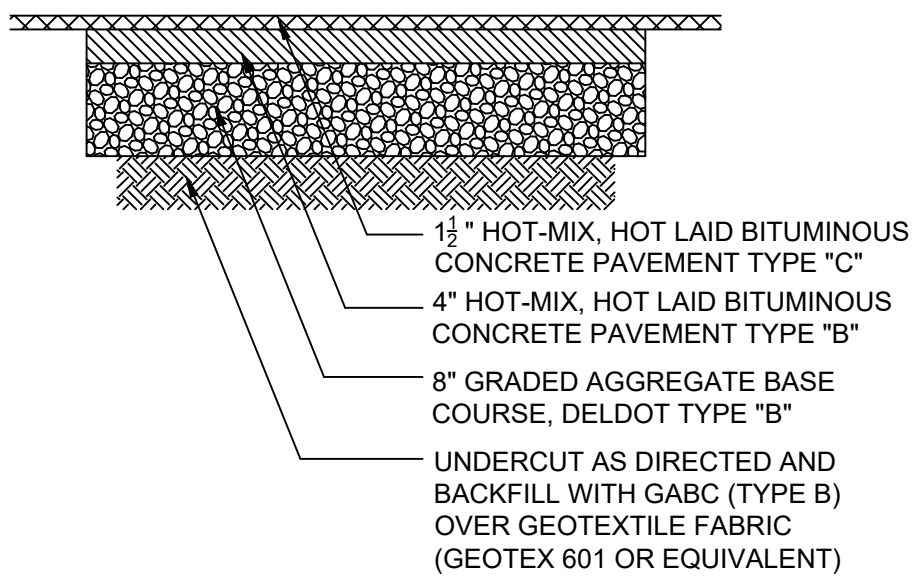

DETAIL: FULL-DEPTH REPLACEMENT
SCALE: NO SCALE

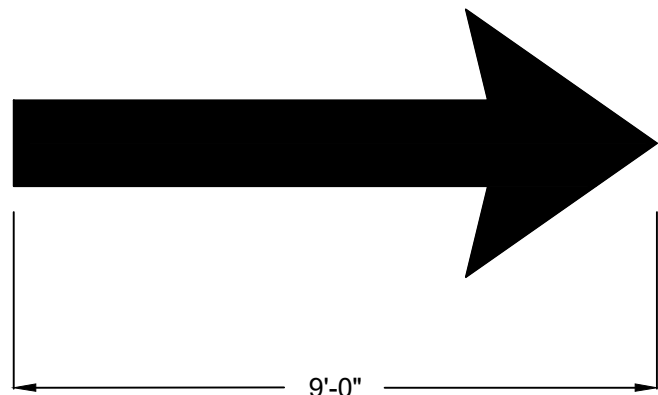

COLOR: WHITE (RETROREFLECTIVE)

DETAIL: DIRECTIONAL ARROW
SCALE: NONE

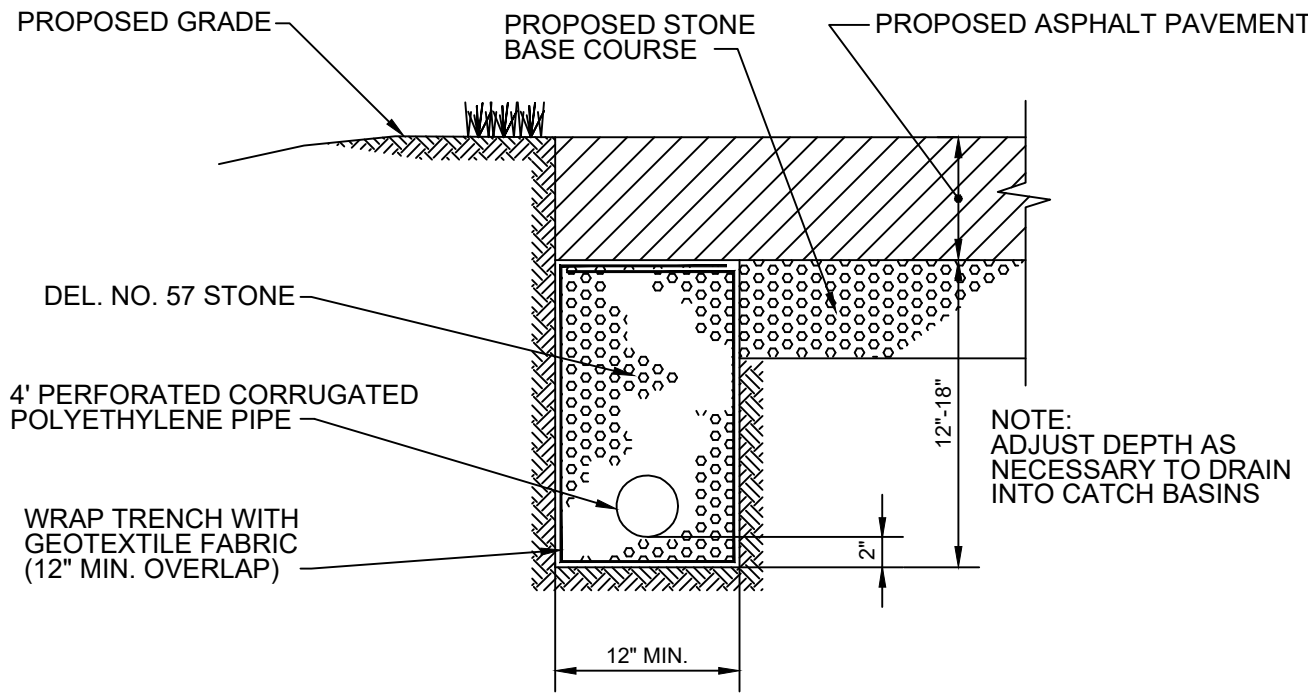

NOTE: INSTALL AS DIRECTED BY ENGINEER

DETAIL: 4" PERFORATED PIPE UNDERDRAIN
SCALE: NO SCALE

GENERAL NOTES:

1. THE CONTRACTOR SHALL BE RESPONSIBLE FOR VERIFYING THE EXISTING AND LOCATION OF UTILITIES BEFORE COMMENCING WORK. IT SHALL BE THE CONTRACTOR'S RESPONSIBILITY TO CONTACT MISS UTILITY OF DELMARVA (TELEPHONE 1.800.282.8555) NO LESS THAN 72 HOURS PRIOR TO INITIATING INTRUSIVE WORK. THE CONTRACTOR SHALL CONTACT THE OWNERS OF UTILITIES AT RISK AS A RESULT OF CONDUCTING THE WORK HEREIN. THE CONTRACTOR SHALL CONSULT WITH UTILITY OWNERS TO OBTAIN THE MOST ACCURATE INFORMATION AVAILABLE WITH REGARD TO UTILITY ELEVATION AND LOCATION.
2. ALL WORK SHALL BE PERFORMED IN ACCORDANCE WITH OSHA GUIDELINES AND THE HEALTH AND SAFETY REQUIREMENTS OF THE OWNER. THE CONTRACTOR SHALL BE RESPONSIBLE FOR MAINTAINING EXCAVATION SAFETY DURING THE PERIOD OF CONSTRUCTION. CONTROL OF GROUNDWATER SEEPAGE AND STORMWATER RUNOFF INTO EXCAVATIONS SHALL BE SOLELY THE RESPONSIBILITY OF THE CONTRACTOR.
3. EXCEPT AS MODIFIED BY THESE NOTES AND THE DETAILED DRAWINGS, ALL WORK SHALL CONFORM TO THE DELAWARE DEPARTMENT OF TRANSPORTATION STANDARD SPECIFICATIONS (MOST RECENT VERSION).
4. ALL EXCESS EXCAVATED MATERIAL, INCLUDING ORGANIC MATERIAL, SOIL, DEBRIS, CONCRETE, ASPHALT AND ROCK SHALL BE DISPOSED OF BY THE CONTRACTOR OFF SITE AT NO ADDITIONAL COST TO THE OWNER.
5. ALL WORK SHALL BE PERFORMED AS COORDINATED WITH OWNER. CONTRACTOR SHALL COORDINATE WITH THE OWNER TO DETERMINE THE SEQUENCE OF WORK.
6. THE COMPLETED PAVEMENT SURFACE SHALL BE GRADED TO MATCH THE SURROUNDING GRADES AND SHAPED TO PROVIDE FOR POSITIVE SURFACE DRAINAGE. THE CONTRACTOR SHALL BE RESPONSIBLE TO ESTABLISH FINAL SITE GRADING THAT PROVIDES POSITIVE SITE DRAINAGE AT ALL AREAS ON THE FINISHED PAVEMENT SURFACE.
7. **MATERIALS**

THE CONTRACTOR SHALL PROVIDE ALL PERMITS, TOOLS, EQUIPMENT, MATERIALS, LABOR AND WORK FOR THE IMPROVEMENT OF THE EXISTING PAVED AREAS AS INDICATED. ALL WORK DONE UNDER THIS ITEM SHALL BE PERFORMED IN A SAFE AND WORKMANLIKE MANNER. MATERIALS REQUIRED INCLUDE, BUT ARE NOT LIMITED TO THE FOLLOWING:

BITUMINOUS CONCRETE SURFACE COURSE: DELDOT TYPE 'C'; HOT MIXED, HOT LAID BITUMINOUS CONCRETE, 160 GYRATIONS, PG64-22 (DELDOT STANDARD SPECIFICATION SECTIONS 401 AND 1014)

BITUMINOUS CONCRETE BASE COURSE: DELDOT TYPE 'B'; HOT MIXED, HOT LAID BITUMINOUS CONCRETE, 160 GYRATIONS, PG 64-22 (DELDOT STANDARD SPECIFICATION SECTIONS 401 AND 1014)

GRADED AGGREGATE BASE COURSE AND UNDERCUT BACKFILL: DELDOT TYPE 'B'; GRADED AGGREGATE (DELDOT STANDARD SPECIFICATION SECTION 1005)

GEOTEXTILE FABRIC (UNDERCUT AREAS): MINIMUM 6 OUNCE NON-WOVEN GEOTEXTILE (GEOTEX 601 OR EQUIVALENT)

TACK COAT: CSS-1-H (DELDOT STANDARD SPECIFICATION SECTION 1011)

BITUMINOUS CONCRETE JOINT SEALANT: HOT POURED JOIN SEALANT (DELDOT STANDARD SPECIFICATION 1042)

8. CONSTRUCTION METHODS

PRIOR TO THE PLACEMENT OF ANY BITUMINOUS CONCRETE, THE EXPOSED BUTT JOINT EDGES, ABUTTING CURBS, SIDEWALKS, AND EXISTING PAVEMENT SHALL BE CLEAN AND A TACK COAT APPLIED TO PROVIDE FULL COVERAGE. THE INTERFACE BETWEEN NEW AND EXISTING PAVEMENT SHALL BE SAWCUT TO A DEPTH OF APPROXIMATELY 1/2 INCH AND BE FILLED WITH A HOT POURED JOIN SEALANT.

BITUMINOUS CONCRETE FULL-DEPTH REPLACEMENT AND PARTIAL-DEPTH REPLACEMENT

ALL LOOSE MATERIAL AND SUBGRADE SHALL BE PROOFROLLED BY A MINIMUM 10-TON VIBRATORY ROLLER OR A FULLY LOADED TANDEM DUMP TRUCK (OR SMALLER MECHANICAL COMPACTOR SUCH AS A PLATE TAMP, JUMPING JACK OR WALK BEHIND ROLLER) IN THE PRESENCE OF A QUALIFIED GEOTECHNICAL ENGINEER ACTING AS THE OWNER'S REPRESENTATIVE IN THE FIELD AND COMPACTED TO 95% STANDARD PROCTOR. ANY SOFT, WET, OR YIELDING AREAS ENCOUNTERED WITHIN THE PAVEMENT AREAS SHALL BE UNDERCUT TO FIRM SUBGRADE AND BACKFILLED AS RECOMMENDED BY THE GEOTECHNICAL ENGINEER. FOR AREAS WHERE UNDERCUTTING IS REQUIRED, THE SUBGRADE SHALL BE IMMEDIATELY COVERED BY THE GEOTEXTILE FABRIC, PULLED TIGHT, AND LAPPED A MINIMUM OF 12 INCHES. GRADED AGGREGATE BACKFILL FOR UNDERCUTS SHALL BE PLACED IN MAXIMUM 8 INCH LIFTS AND COMPACTED WITH A MINIMUM OF 3 PASSES WITH A 10-TON VIBRATORY ROLLER (OR SMALLER MECHANICAL COMPACTOR) IN THE PRESENCE OF A QUALIFIED GEOTECHNICAL ENGINEER PROVIDED BY THE OWNER.

THE COMPACTED PAVEMENT SURFACE SHALL BE GRADED TO MATCH THE SURROUNDING GRADES AND SHAPED TO PROVIDE FOR POSITIVE DRAINAGE. THE CONTRACTOR SHALL BE RESPONSIBLE TO ESTABLISH FINAL SITE GRADING THAT PROVIDES POSITIVE SITE DRAINAGE AT ALL AREAS ON THE FINISHED PAVEMENT SURFACE. FOLLOWING ITS PLACEMENT, THE SURFACE AND BINDER COURSES SHALL BE COMPACTED IN ACCORDANCE WITH DELDOT STANDARD SPECIFICATION REQUIREMENTS (MINIMUM OF 92% COMPACTION OF THE THEORETICAL VOIDLESS DENSITY (TVD) FOR SURFACE COURSE AND MINIMUM OF 90% COMPACTION OF THE TVD FOR BINDER COURSE).

ALL NEW LONGITUDINAL PAVEMENT MARKINGS SHALL BE EPOXY RESIN PAINT MARKINGS, AND ALL NEW SHORT / TRANSVERSE AND SYMBOL MARKINGS SHALL BE HOT THERMOPLASTIC.

PAVEMENT STRIPING AND MARKINGS SHALL MATCH EXISTING AND SHOULD BE DOCUMENTED BY CONTRACTOR PRIOR TO START OF WORK. THESE PLANS SHOULD NOT BE USED FOR PAVEMENT MARKING RESTORATION.

SITE GRADING

LANDSCAPED AREAS DISTURBED DURING CONSTRUCTION SHALL BE STABILIZED TO INCLUDE 4" OF TOPSOIL, PERMANENT SEEDING (DNREC E&S CONTROL HANDBOOK MIX NO. 3), AND EROSION CONTROL MATTING (STRAW AND NETTING, LANDLOK S1 OR EQUIVALENT)

9. THESE DRAWINGS SHALL ONLY BE USED IN CONJUNCTION WITH THE PROJECT MANUAL TITLED "SPECIFICATIONS FOR PAVEMENT IMPROVEMENTS AT DICKINSON HIGH SCHOOL," CONTRACT NO. XXXX, PREPARED BY DUFFIELD ASSOCIATES, INC., DATED XXXX.
10. THE FOLLOWING ITEMS ARE CONSIDERED INCIDENTAL TO THE PAVEMENT CONSTRUCTION INCLUDING BUT NOT LIMITED TO:
 - 10.1. SPEED BUMP RECONSTRUCTION
 - 10.2. RE-INSTALLATION OF INDUCTIVE LOOP DETECTORS AT EXIT DRIVEWAY
 - 10.3. REMOVAL AND REINSTALLATION OF BUMPER BLOCKS WITH REPLACEMENT OF BLOCKS DAMAGED DURING MOVING
 - 10.4. REMOVAL AND DISPOSAL OF BITUMINOUS CURB



5400 LIMESTONE ROAD
WILMINGTON, DE 19808-1232
TEL: 302.239.6634
FAX: 302.239.8485

OFFICES IN DELAWARE, MARYLAND,
PENNSYLVANIA AND NEW JERSEY
WEB: [HTTP://DUFFNET.COM](http://duffnet.com)
E-MAIL: [DUFFNET@DUFFNET.COM](mailto:duffnet@duffnet.com)

DETAILS AND NOTES

PAVEMENT IMPROVEMENTS

H.B. DUPONT MIDDLE SCHOOL

735 MEETING HOUSE ROAD

HOCKESSIN ~NEW CASTLE COUNTY ~ DELAWARE

DATE: 4 MAY 2020
SCALE: N.T.S.
PROJECT NO. 12571.GB
SHEET: 2 OF 2