

## M E M O R A N D U M

**TO:** Attendees

**FROM:** Joseph Jakubowski, P.E., LEED AP *JJ*  
 Stephen J. Gorski, P.E.

**DATE:** December 11, 2015

**RE:** Project No. 5858.CG  
 Addendum No. 2  
 Parking Lot Improvements  
 Stockley Center Campus  
 Georgetown, Delaware

**This Addendum No. 2 becomes part of the Contract Documents. Please acknowledge receipt of this Addendum in the space provided on Page 3 of the Bid Form.**

- The following questions were received following the pre-bid meeting. The questions and answers should be considered during preparation of bids for the project.

Question: Plantings are not shown on the plans, nor referenced in the specifications. There is a generic reference to plantings on sheet 4 of 7 of the Sediment and Stormwater Management Plan. Are plantings to be a part of this project? If so, can a schedule be made available?

Sheet 4 of 7 of the Sediment and Stormwater Management Plan references the potential need for temporary irrigation. As there seems to be no plantings within the scope of this project, will temporary irrigation be necessary?

Answer: Bidders shall include costs for providing and installing the following plantings within the bioretention area, and providing temporary irrigation as required:

Botanical Name	Quantity
Eupatorium dubium	100
Panicum virgatum	110
Rudbeckia hirta	118
Cornus sericea "Allemans"	15
Ilex verticillata	20
Amelanchier canadensis	2

Question: Can the prevailing contractor anticipate using excavated soils as borrow for placing the berm around the pond and for filling the abandoned road?

Answer: Yes, excavated material and topsoil can be used for the berm construction and removal of the roadway. Please see the attached log for details related to a test pit performed in the approximate location of the proposed bioretention.

Question: The plans have two references for a Gravel Diaphragm but no location is explicitly given.

Answer: A gravel diaphragm is specified to the north and east of the parking lot located at 102 Lloyd Lane. See Sediment and Stormwater Drawing No. 3 and Construction Drawing C4.

Question: Regarding means and methods, will equipment be allowed within the SAP for the pond once the rice gravel is place for the purpose of leveling and placing biosoil/mulch?

Answer: Use of equipment following placement of rice gravel is not permitted.

2. The following modifications/clarifications, to the bid documents, shall be considered in preparation of a bid:

- The scope for Alternate No. 1 shall include the addition of approximately 30 LF of 1 ½ -inch asphalt overlay to tie the new pavement grade to an existing raised asphalt joint north of the project area. A sketch is include with this Addendum.
- A revised bid form is included with this Addendum. Bidders shall utilize the revised bid form.

Bids are due on Wednesday, December 16, 2015, at 2:00 p.m. Sealed bids shall be addressed to the Division of Facilities Management, Thomas Collins Building, 540 South DuPont Highway, Third Floor, Dover, Delaware 19901. The outer envelope should clearly indicate:

- "OMB/DFM CONTRACT NO. MC3511000025 - SEALED BID - DO NOT OPEN."

A public bid opening will follow.

JJ/  
5858CG.1215-ADDENDUM2.MEM

Enclosure: Duffield Associates' Test Pit No. IT-3 Log (1 page)  
A sketch titled "Addendum #2, Site and Grading Plan-Site 2, Stockley Center Campus Parking Lot Improvements," dated December 11, 2015 (1 page)  
Revised Bid Form (6 pages)



## TEST PIT DESCRIPTIVE LOG

PROJECT: Stockley Center Campus – Parking Lot Upgrades      PROJECT NO.: 5858.CG

CLIENT: State of Delaware OMB/DFM

DATE: May 5, 2015

LOGGED BY: JJ

<u>Test Pit No.</u>	<u>Depth Range (feet below existing ground surface)</u>	<u>Generalized Soil Description</u>
IT-3 Elev. 31 ft. ±	0.0 – 0.8	Brown fine SAND, little to trace silt, trace organics (e.g., roots) (dry to moist, loose)
	0.8 – 3.0 S-1 at 2.0	Orange brown fine SAND, little to some silt, trace medium sand (moist, loose to medium dense)
	3.0 – 5.8 S-2 at 3.3 S-3 at 4.0 (prior to testing) S-4 at 4.0 (after testing) S-5 at 5.0	Light brown fine to medium SAND, trace to little silt (moist, medium dense) <ul style="list-style-type: none"> <li>• Moisture Content: 16.0%</li> <li>• Percent Passing No. 270 Sieve: 21.5%</li> </ul>
	5.8 – ---	Yellow-brown fine SAND, trace to some silt, trace medium sand (moist, medium dense)

**NOTES:**

- (1) Test pit excavated by CGC Geoservices, LLC utilizing a CX36 Case Mini Excavator.
- (2) Infiltration testing performed at approximately 4.0 feet below the existing ground surface (b.e.g.s.)
- (3) Test pit terminated approximately 7.0 feet b.e.g.s.
- (4) Groundwater or indications of seasonal high ground water were not observed during the performance of the test pit excavation.
- (5) Borehole backfilled with excavated soils upon completion.
- (6) Soil descriptions and classification were performed in general accordance with ASTM D 2488 (Visual-Manual Procedure), and ASTM D 2487 (Unified Soil Classification System, USCS).

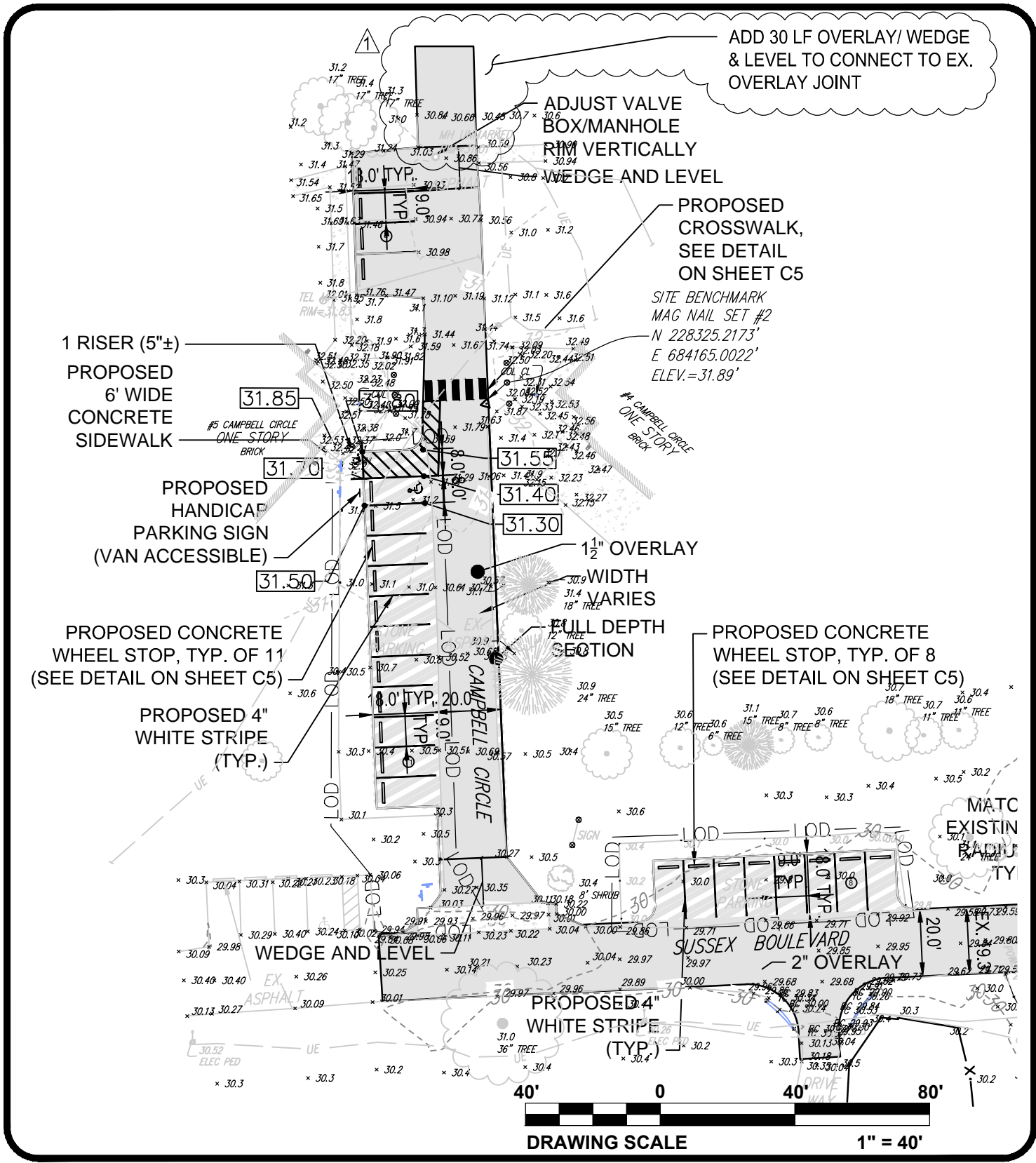

<b>DATE:</b> 11 DECEMBER 2015
<b>SCALE:</b> 1" = 40'
<b>PROJECT. NO.</b> 5858.CG
<b>SHEET:</b> EXHIBIT 1B

**ADDENDUM #2**

**SITE AND GRADING PLAN-SITE 2**

**STOCKLEY CENTER CAMPUS**

**PARKING LOT IMPROVEMENTS**

GEORGETOWN HUNDRED~SUSSEX COUNTY~DELAWARE

<b>DESIGNED BY:</b> SJG
<b>DRAWN BY:</b> RCN
<b>CHECKED BY:</b> SJG
<b>FILE:</b> A5858.CG-Addendum 2

**DUFFIELD ASSOCIATES**  
Soil, Water & the Environment

5400 LIMESTONE ROAD  
WILMINGTON, DE 19808-1232  
TEL. 302.239.6634  
FAX 302.239.8485

OFFICES IN DELAWARE, MARYLAND  
PENNSYLVANIA AND NEW JERSEY

E-MAIL: DUFFIELD@DUFFNET.COM

**PARKING LOT UPGRADES  
STOCKLEY CENTER CAMPUS  
GEORGETOWN, DELAWARE  
OMB/DFM PROJECT NO. MC3511000025**

**BID FORM (REVISED 12/11/15)**

For Bids Due: December 16, 2015 at 2:00 pm To: State of Delaware  
Office of Management and Budget  
Division of Facilities Management  
540 South DuPont Highway, Suite 1  
Dover, DE 19901

Name of Bidder: \_\_\_\_\_

Delaware Business License No.: \_\_\_\_\_ Taxpayer ID No.: \_\_\_\_\_  
(A copy of a Bidders Delaware Business License must be attached to this form.)

(Other License Nos.): \_\_\_\_\_  
\_\_\_\_\_

Phone No.: ( ) \_\_\_\_\_ - \_\_\_\_\_ Fax No.: ( ) \_\_\_\_\_ - \_\_\_\_\_

The undersigned, representing that he has read and understands the Bidding Documents and that this bid is made in accordance therewith, that he has visited the site and has familiarized himself with the local conditions under which the Work is to be performed, and that his bid is based upon the materials, systems and equipment described in the Bidding Documents without exception, hereby proposes and agrees to provide all labor, materials, plant, equipment, supplies, transport and other facilities required to execute the work described by the aforesaid documents for the "lump sum" Base Bid itemized below:

\$ \_\_\_\_\_  
( \$ )

**ALTERNATES**

Alternate prices conform to applicable project specification section. Refer to specifications for a complete description of the following Alternates. An "ADD" or "DEDUCT" amount is indicated by the crossed out part that does not apply.

ALTERNATE No. 1: Pavement Improvements for Campbell Circle and Sussex Boulevard

Add/Deduct: \_\_\_\_\_  
( \$ )

**PARKING LOT UPGRADES  
STOCKLEY CENTER CAMPUS  
GEORGETOWN, DELAWARE  
OMB/DFM PROJECT NO. MC3511000025**

**BID FORM (REVISED 12/11/15)**

**UNIT PRICES**

Unit prices conform to applicable project specification section. Refer to the specifications for a complete description of the following Unit Prices:

	<u>DEDUCT</u>	<u>ADD</u>
UNIT PRICE No. 1: <u>Undercutting (cubic yard)</u>	\$ <u>N/A</u>	\$ <u>\$50.00/cy</u>

**PARKING LOT UPGRADES  
STOCKLEY CENTER CAMPUS  
GEORGETOWN, DELAWARE  
OMB/DFM PROJECT NO. MC3511000025**

**BID FORM (REVISED 12/11/15)**

I/We acknowledge Addendums numbered \_\_\_\_\_ and the price(s) submitted include any cost/schedule impact they may have.

This bid shall remain valid and cannot be withdrawn for thirty (30) days from the date of opening of bids (60 days for School Districts and Department of Education), and the undersigned shall abide by the Bid Security forfeiture provisions. Bid Security is attached to this Bid.

The Owner shall have the right to reject any or all bids, and to waive any informality or irregularity in any bid received.

This bid is based upon work being accomplished by the Sub-Contractors named on the list attached to this bid.

Should I/We be awarded this contract, I/We pledge to achieve substantial completion of all the work within \_\_\_ calendar days of the Notice to Proceed.

The undersigned represents and warrants that he has complied and shall comply with all requirements of local, state, and national laws; that no legal requirement has been or shall be violated in making or accepting this bid, in awarding the contract to him or in the prosecution of the work required; that the bid is legal and firm; that he has not, directly or indirectly, entered into any agreement, participated in any collusion, or otherwise taken action in restraint of free competitive bidding.

Upon receipt of written notice of the acceptance of this Bid, the Bidder shall, within twenty (20) calendar days, execute the agreement in the required form and deliver the Contract Bonds, and Insurance Certificates, required by the Contract Documents.

I am / We are an Individual / a Partnership / a Corporation

By \_\_\_\_\_ Trading as \_\_\_\_\_  
(Individual's / General Partner's / Corporate Name)  
\_\_\_\_\_  
(State of Corporation)

Business Address: \_\_\_\_\_  
\_\_\_\_\_  
\_\_\_\_\_  
\_\_\_\_\_

**Witness:** \_\_\_\_\_ **By:** \_\_\_\_\_  
(SEAL) ( Authorized Signature )  
\_\_\_\_\_  
( Title )  
**Date:** \_\_\_\_\_

- ATTACHMENTS**  
Sub-Contractor List  
Non-Collusion Statement  
Bid Security  
(Others as Required by Project Manuals)

**PARKING LOT UPGRADES  
STOCKLEY CENTER CAMPUS  
GEORGETOWN, DELAWARE  
OMB/DFM PROJECT NO. MC3511000025**

**BID FORM (REVISED 12/11/15)**

**SUBCONTRACTOR LIST**

In accordance with Title 29, Chapter 6962 (d)(10)b Delaware Code, the following sub-contractor listing must accompany the bid submittal. The name and address of the sub-contractor **must be listed for each category** where the bidder intends to use a sub-contractor to perform that category of work. In order to provide full disclosure and acceptance of the bid by the *Owner*, **it is required that bidders list themselves as being the sub-contractor for all categories where he/she is qualified and intends to perform such work.**

<u>Subcontractor Category</u>	<u>Subcontractor</u>	<u>Address (City &amp; State)</u>	<u>Subcontractors tax payer ID # or Delaware Business license #</u>
1. Maintenance of Traffic	_____	_____	_____
2. Demolition	_____	_____	_____
3. Pavement Construction	_____	_____	_____
4. Concrete Construction	_____	_____	_____
5. Site Work	_____	_____	_____
6. Landscaping	_____	_____	_____



**PARKING LOT UPGRADES  
STOCKLEY CENTER CAMPUS  
GEORGETOWN, DELAWARE  
OMB/DFM PROJECT NO. MC3511000025**

**BID FORM (REVISED 12/11/15)**

<u>Subcontractor Category</u>	<u>Subcontractor</u>	<u>Address (City &amp; State)</u>	<u>Subcontractors tax payer ID # or Delaware Business license #</u>
7. Pavement Markings	_____	_____	_____
8. Parking Signage	_____	_____	_____

**PARKING LOT UPGRADES  
STOCKLEY CENTER CAMPUS  
GEORGETOWN, DELAWARE  
OMB/DFM PROJECT NO. MC3511000025**

**BID FORM (REVISED 12/11/15)**

**NON-COLLUSION STATEMENT**

This is to certify that the undersigned bidder has neither directly nor indirectly, entered into any agreement, participated in any collusion or otherwise taken any action in restraint of free competitive bidding in connection with this proposal submitted this date *(to the Office of Management and Budget, Division of Facilities Management)*.

All the terms and conditions of OMB/DFM Project No. MC3511000025 have been thoroughly examined and are understood.

**NAME OF BIDDER:** \_\_\_\_\_

**AUTHORIZED REPRESENTATIVE  
(TYPED):** \_\_\_\_\_

**AUTHORIZED REPRESENTATIVE  
(SIGNATURE):** \_\_\_\_\_

**TITLE:** \_\_\_\_\_

**ADDRESS OF BIDDER:** \_\_\_\_\_  
\_\_\_\_\_  
\_\_\_\_\_

**E-MAIL:** \_\_\_\_\_

**PHONE NUMBER:** \_\_\_\_\_

Sworn to and Subscribed before me this \_\_\_\_\_ day of \_\_\_\_\_ 20\_\_\_\_.

My Commission expires \_\_\_\_\_. NOTARY PUBLIC \_\_\_\_\_.

**THIS PAGE MUST BE SIGNED AND NOTARIZED FOR YOUR BID TO BE CONSIDERED.**