



State of Delaware  
Department of Natural Resources and Environmental Control  
**Delaware Division of Parks and Recreation**  
89 Kings Highway  
Dover, Delaware 19901

**ADDENDUM No. ONE**

Project Name: Holts Landing Boardwalk & Trail Improvements  
Holts Landing State Park

Project No.: HL-10C

Date of Issue: February 12, 2019

Notice No. 1: Attach this addendum to the Project Manual for this project. It modifies and becomes part of the Bidding Documents. Work or material not specifically mentioned herein is to be as described in the main body of the specification and as shown on the drawings.

Bids Due: Wednesday, February 27, 2019 at 2:00 PM  
DNREC Division of Parks and Recreation  
Richardson and Robbins Building, **Auditorium**  
89 Kings Highway  
Dover, DE 19901

---

General Information:

1. A mandatory pre-bid meeting was held at the project site on Thursday, February 7, 2019, at 11:00 a.m.. A copy of the Agenda and Sign-In Sheet is included with this addendum.

Pre-bid Meeting Discussion:

1. Refer to the attached Agenda for the formal discussion at the Pre-Bid Meeting.
2. The requirement for Buy America was noted by the Engineer. The contractor shall refer to Section 006277 – Buy America.
3. Work restrictions in the wetlands between March 1 and June 30, 2019 are in effect for this construction. The Contractor shall schedule work accordingly.
4. The Contractor is responsible for checking the State web site for any subsequent Addendums or changes to the project prior to bidding.

## Drawings

1. Plan Sheet C301: Added Project Notes 2 and 22.
2. Plan Sheet C301, Revised Detail A, B, and C, Typical Section: 4.00' Wide Gravel Trail to be widened to 5.00'.
3. Plan Sheet C306: Deleted all signing and striping requirements from this contract.
4. Plan Sheet SSMP500.1: Removed the Stabilized Construction Entrance (SCE) at the intersection of Holts Landing Road and the existing parking lot. The Contractor shall be responsible for sweeping the existing parking lot clean of all tracked debris at the end of each work day.

## Specifications

1. New Section 004113 - Bid Form, with revision to Unit Price.
2. New Section 012200 - Unit Prices, with revision to Unit Price 1 for Helical Screw Foundations. All items noted within Section 012200 – Unit Prices, are to be included in the Base Bid.
  - a. Add the following “For bidding purposes, Helical Anchors quantities shall assume pile lengths of 40 feet for all plumb and battered piles measured from the tip to the point of cut-off. Contractor shall not be paid for excess pile trimmed off the end of the pile to meet cut-off elevation. Contractor shall maintain a log of the linear foot quantity of helical piles installed and shall submit updated installation quantities to the owner on a weekly basis.”

## Questions

1. **In the bid documents it does not give an over all length or a base quantity for the helical pile but just a unit price per foot. I believe that quantity may be between 2000' and 3000' and without borings it could go higher. I believe it would be hard to evaluate the bids without a bid quantity with a add/deduct. Can you review this item?**

A: Contractors shall provide a Base Bid that includes 8,760 linear feet of helical pile, measured from pile tip to cut-off elevation. Unit Price No. 1 shall be revised to measure helical piles using Linear Feet (LF).

2. **Is soil testing required:**

A: The contractor is responsible for any soil borings deemed necessary for the design of the helical piles. This testing shall be the contractor's option and shall be included in the Base Bid.

3. **Drug Testing: Do we need new drug tests on the employees for the job or are the test results that we have on file okay?**

A: All drug testing results must be current in accordance with Section 008114 – Drug Testing Forms. The Contractor shall submit documentation for all employees.

**4. It looks like the contractor is responsible for all permits, i.e. grading, starting....**

A: Permits have been obtained from: Division of Facilities Management; Architectural Accessibility Board; DNREC Division of Watershed Stewardship; DNREC Wetlands and Subaqueous Lands. No permits are required for site work for this project.

**5. For spoils to be hauled off of the site, is testing of the materials require to dispose of this?**

A: All soils to be hauled off site shall become the property and responsibility of the owner to legally dispose of. Any testing will be the responsibility of the contractor to comply with any applicable codes and/or laws.

**6. At the boardwalk areas, is the LOD Width still 8' or is it wider in these two area?**

A: The LOD width at the boardwalk areas includes 8.0' for the boardwalk plus another 8.0' for matting, as noted on Plan Sheet SSMP500. Total LOD width is 16.0'.

**7. I went to the Pre-Bid Meeting for Holts Landing Boardwalk Trail Improvements, NAT18200-HL. Would I be able to get a copy of the sign-in sheet?**

A: A copy of the sign in sheet is included with this Addendum.

**8. I was wondering if a copy of the sign in sheet is available from the mandatory prebid meeting that was held yesterday?**

A: Refer to question #7.

**End of Addendum No. One**

Enclosures

File:





State of Delaware  
Department of Natural Resources and Environmental Control  
**Delaware Division of Parks and Recreation**  
89 Kings Highway  
Dover, Delaware 19901

## **PRE-BID MEETING AGENDA**

Date: February 7, 2019  
To: File  
From: Julio Seneus  
Subject: Holts Landing State Park  
Holts Landing Boardwalk & Trail Improvement  
Contract No.: 2018-HL-200  
Project No.: HL-10C  
Meeting Date: February 7, 2019  
Location: Holts Landing State Park Maintenance Building

### **ADMINISTRATIVE:**

**Sign-In Sheet:** Please make sure to fill out the sign in sheet, otherwise you will not be considered in attendance and will not be permitted to submit a bid.

**Questions During Bidding:** All questions shall be submitted via email to [Cindy.Todd@delaware.gov](mailto:Cindy.Todd@delaware.gov). Last Day for Questions shall be **February 20, 2019** (2:00 PM) any questions received after this time will not be addressed. Questions will be answered via Addendum. Phone calls will not be replied to.

**Bonds:** Bid bond is required and is required to be submitted with your bid. Bond forms are included in the bid package Performance and Payroll bonds will be required for the work. Bond forms are included in the bid package and will be required upon notice of award of the contract, along with a certificate of insurance.

**Wages/Payroll:** Prevailing wage and payroll reporting are applicable to this project. The project determination is Highway Construction.

**Bids Due:** **Wednesday February 27, 2019 at 2:00 PM** Local Time. Any bid received after the stated time will be returned unopened. Bids shall be accepted by overnight mail, or in person at DNREC – Division of Parks and Recreation, 89 Kings Highway, Dover DE 19901.

Sealed Bids shall be addressed to the following address, the outer envelope shall clearly indicate **"DNREC CONTRACT NO. 2018-HL-200, SEALED BID – DO NOT OPEN"**.

**Sealed Bids shall be addressed to the following address:**

Dept. of Natural Resources & Environmental Control  
Division of Parks and Recreation  
Office of Design and Development  
89 Kings Highway, Dover DE 19901  
Attn: Cynthia A. Todd, RLA. Phone Number: 302-739-9210

**Bids will be opened and read aloud in the DNREC Auditorium.**

**Unit Prices, Section 012700:**

Please note, only one (1) Unit Price is required for this project:

- Unit Price No. 1 – Helical Screw Foundations (EA). Please include a price to Add and Deduct this item.

**On-Site Superintendent:** The contractor shall designate a superintendent who shall be on site for the duration of the project.

**Completion of Work:**

- Notice of Contract Award: Within thirty (30) days of receipt and acceptance of qualified low bid.
- Purchase Order Issuance: The issuance of a State of Delaware purchase order is contingent upon the successful Contractor submitting bonds on State-approved forms, signed contracts and insurance certificates to the State of Delaware within 20 days of Notice of Award. A purchase order will be issued in approximately thirty days after these items have been submitted to the State of Delaware.
- On-Site Mobilization: Upon receipt of State of Delaware purchase order.
- Substantial Completion: The work shall be completed **180 calendar days** from on-site start of work.
- Completion of Punch List: 21 days from date of substantial completion.

**Shop Drawings:** All shop drawings and Source of Supply documents will be submitted electronically to the project to the DNREC Project Manager. The contractor will designate a point of contact for access. The project design team will have 15 days to review and respond to all shop drawings and Source of Supply documents. Please consider this when making submissions and scheduling the work.

**Successful Bidder** will be expected to enter into a Standard A101-2007 Agreement between Owner and Contractor.

**SCOPE OF WORK:**

**Base Bid:**

- Construction of a new, 1,304+/- long, 5-foot wide gravel trail.
- Construction of one (1) 600' boardwalk and overlook, and one (1) 55' boardwalk.
- Placement of GABC and DE No. 10 Stone on approximately 4,416 linear feet of the existing Sea Hawk Trail as shown on the Contract Plans.

- Construction of 1,200+/- linear feet of 5-foot wide gravel trail adjacent to the parking lot, to be located in the field by the owner.

Work will also include stormwater management as shown on the plans.

**PLEASE NOTE: All work with the wetlands shall be performed from matting placed within the limit of disturbance (LOD).**

**Alternates, Section 012300:**

- Alternate 1: Split-Rail Fence.
  - State the amount to be added to the Base Bid to construct 360 linear feet of split-rail fence per location & detail on plan sheet **C306**.
- Alternate 2: Helical Pile Static Load Testing
  - State the amount to be **deducted** from the Base Bid to eliminate load testing one (1) helical pile at each bridge abutment, total four (4) tests.

**FIELD WALK/QUESTIONS:**



PRE-BID MEETING ATTENDANCE SHEET  
**HOLTS LANDING BOARDWALK & TRAIL IMPROVEMENTS**  
 CONTRACT NO. 2018-HL-200, Project #HL-10C  
 Thursday, February 7, 2019 at 11:00 AM

<u>NAME</u>	<u>AGENCY/COMPANY</u>	<u>PHONE/E-MAIL</u>
Kyle Morgan	Diamond Materials	Phone # <u>302-463-2832</u> E-Mail <u>Kmorgan@diamondmaterials.com</u>
Chuck Swartzout	CrossBusters Landscaping	Phone # <u>302-292-1166</u> E-Mail <u>Picousee AOL.COM</u>
CHARLES DOLBEY	MURTECH, INC	Phone # <u>410.251.3812</u> E-Mail <u>cdolbey@murtech.us</u>
Tanner Jennings	Murtech, Inc	Phone # <u>410-713-5181</u> E-Mail <u>tjennings@murtech.us</u>
ED BUSH	EPB ASSOCIATES, INC	Phone # <u>302-475-7301</u> E-Mail <u>epbush@Aol.com</u>
Bill Booth	COMMONWEALTH CONCRETE CO.	Phone # <u>302-654-6611</u> E-Mail <u>bbooth@itscommonwealth.com</u>
Brian C Thompson	Conventional Builders INC	Phone # <u>302-422-2429</u> E-Mail <u>conventionalbuilders@aol.com</u>
Kathy Ferguson	Mumford & Miller	Phone # <u>302 373 5771</u> E-Mail <u>KFerguson@MumfordandMiller.com</u>
Rick Pizaray	Amakoe Inc	Phone # <u>302-834-9664</u> E-Mail <u>Amakoe@aol.com</u>
		Phone # _____



<u>NAME</u>	<u>AGENCY/COMPANY</u>	<u>PHONE/E-MAIL</u>
Greg Thompson	Conventional Builders Inc	E-Mail <u>Conventional builders @ Comcast.net</u>
Myr Tucke	Chesapeake Turf LLC	Phone # _____ E-Mail <u>greg@chesapeake-turf.com</u>
Daniel G. Gange	UCC	Phone # <u>(715) 413-1000</u> E-Mail <u>dan@ucc-llc.us</u>
Bill Boyd	Construction Agents / Sub-Contract DBE	Phone # <u>(302) 287-0322</u> E-Mail <u>TheCACorp@gmail.com</u>
MA77 TARR	G.E.S.	Phone # <u>302-757-2883</u> E-Mail <u>MTARR@GESOMCML.COM</u>
Leon Thompson Jr	EDIS	Phone # <u>302-528-1067</u> E-Mail <u>lthompson@ediscompany.com</u>
Jim DiGuglielmo	EDIS	Phone # <u>302-383-4405</u> E-Mail <u>Jim@ediscompany.com</u>
Susan Trentham	JJID	Phone # <u>302-836-0419 ext 113</u> E-Mail <u>strenthan@jjid.com</u>
Jonathan Kwesi' Liggie	Liggie Surveys Inc.	Phone # <u>202-702-7995</u> Fax # <u>202-379-7995</u> E-Mail <u>jliggie@liggiesurveys.com</u>
		Phone # _____

[illegible]

[illegible]

HOLTS LANDING BOARDWALK & TRAIL IMPROVEMENTS  
HOLTS LANDING STATE PARK  
DIVISION OF PARKS AND RECREATION CONTRACT No. 2018-HL-200

**BID FORM**

For Bids Due: **February 27, 2019, at 2:00 p.m.**  
Control

To: Dept. of Natural Resources and Environmental

Division of Parks and Recreation  
Office of Design and Development  
89 Kings Highway, Dover DE 19901

**Name of Bidder:** \_\_\_\_\_

**Delaware Business License No.:** \_\_\_\_\_ **Taxpayer ID No.:** \_\_\_\_\_  
(A copy of Bidder's Delaware Business License must be attached to this form.)

**(Other License Nos.):** \_\_\_\_\_

**Phone Number:** ( ) \_\_\_\_\_ **Fax Number:** ( ) \_\_\_\_\_

The undersigned, representing that he has read and understands the Bidding Documents and that this bid is made in accordance therewith, that he has visited the site and has familiarized himself with the local conditions under which the Work is to be performed, and that his bid is based upon the materials, systems and equipment described in the Bidding Documents without exception, hereby proposes and agrees to provide all labor, materials, plant, equipment, supplies, transport and other facilities required to execute the work described by the aforesaid documents for the lump sum itemized below:

\$ \_\_\_\_\_

( \$ )

HOLTS LANDING BOARDWALK & TRAIL IMPROVEMENTS  
HOLTS LANDING STATE PARK  
DIVISION OF PARKS AND RECREATION CONTRACT No. 2018-HL-200

**BID FORM**

ALTERNATES

Alternate prices conform to applicable project specification section. Refer to specifications for a complete description of the following Alternates. An “ADD” or “DEDUCT” amount is indicated by the crossed out part that does not apply.

ALTERNATE No. 1: Split-Rail Fence

Add/Deduct: \_\_\_\_\_  
(\$ \_\_\_\_\_ )

No. of Days to Complete Alternate 1: \_\_\_\_\_

ALTERNATE No. 2: Helical Pile Static Load Testing

Add/Deduct: \_\_\_\_\_  
(\$ \_\_\_\_\_ )

No. of Days to Complete Alternate 2: \_\_\_\_\_

HOLTS LANDING BOARDWALK & TRAIL IMPROVEMENTS  
HOLTS LANDING STATE PARK  
DIVISION OF PARKS AND RECREATION CONTRACT No. 2018-HL-200

**BID FORM**

UNIT PRICES

Unit prices conform to applicable project specification section. Refer to the specifications for a complete description of the following Unit Prices:

		DEDUCT	ADD
UNIT PRICE No. 1:	Helical Screw Foundations ( <del>EA</del> ) ( <u>LF</u> )	\$ _____	\$ _____
UNIT PRICE No. 2:	Disposal of Excess Material (CY)	\$ _____	\$ _____
UNIT PRICE No. 3:	Additional Gravel Trail (LS)	\$ _____	\$ _____

**HOLTS LANDING BOARDWALK & TRAIL IMPROVEMENTS**  
**HOLTS LANDING STATE PARK**  
**DIVISION OF PARKS AND RECREATION CONTRACT No. 2018-HL-200**

**BID FORM**

I/We acknowledge Addendums numbered \_\_\_\_\_ and the price(s) submitted include any cost/schedule impact they may have.

This bid shall remain valid and cannot be withdrawn for thirty (30) days from the date of opening of bids, and the undersigned shall abide by the Bid Security forfeiture provisions. Bid Security is attached to this Bid.

The Owner shall have the right to reject any or all bids, and to waive any informality or irregularity in any bid received.

This bid is based upon work being accomplished by the Sub-Contractors named on the list attached to this bid.

Should I/We be awarded this contract, I/We pledge to achieve substantial completion of all the work within \_\_\_\_\_ calendar days of the Notice to Proceed.

The undersigned represents and warrants that he has complied and shall comply with all requirements of local, state, and national laws; that no legal requirement has been or shall be violated in making or accepting this bid, in awarding the contract to him or in the prosecution of the work required; that the bid is legal and firm; that he has not, directly or indirectly, entered into any agreement, participated in any collusion, or otherwise taken action in restraint of free competitive bidding.

Upon receipt of written notice of the acceptance of this Bid, the Bidder shall, within twenty (20) calendar days, execute the agreement in the required form and deliver the Contract Bonds, and Insurance Certificates, required by the Contract Documents.

I am / We are an Individual / a Partnership / a Corporation

By \_\_\_\_\_ Trading as \_\_\_\_\_  
(Individual's/General Partner's /Corporate Name)

\_\_\_\_\_  
(State of Corporation)

Business Address: \_\_\_\_\_  
\_\_\_\_\_  
\_\_\_\_\_

Witness: \_\_\_\_\_

(Seal)

By: \_\_\_\_\_  
(Authorized Signature)

\_\_\_\_\_  
(Title)

Date: \_\_\_\_\_

**ATTACHMENTS**

Sub-Contractor List  
Non-Collusion Statement  
Affidavit(s) of Employee Drug Testing Program  
Bid Security  
(Others as Required by Project Manual)

**BID FORM**

00 41 13 - 4

HOLTS LANDING BOARDWALK & TRAIL IMPROVEMENTS  
HOLTS LANDING STATE PARK  
DIVISION OF PARKS AND RECREATION CONTRACT No. 2018-HL-200

BID FORM

SUBCONTRACTOR LSIST

In accordance with Title 29, Chapter 6962 (d)(10)b Delaware Code, the following sub-contractor listing must accompany the bid submittal. The name and address of the sub-contractor **must be listed for each category** where the bidder intends to use a sub-contractor to perform that category of work. In order to provide full disclosure and acceptance of the bid by the *Owner*, **it is required that bidders list themselves as being the sub-contractor for all categories where he/she is qualified and intends to perform such work.**

Subcontractor Category	Subcontractor	Address (City & State)	Subcontractors tax payer ID # or Delaware Business license #
1.			
2.			
3.			
4.			
5.			
6.			
7.			
8.			



HOLTS LANDING BOARDWALK & TRAIL IMPROVEMENTS  
HOLTS LANDING STATE PARK  
DIVISION OF PARKS AND RECREATION CONTRACT No. 2018-HL-200

**BID FORM**

NON-COLLUSION STATEMENT

This is to certify that the undersigned bidder has neither directly nor indirectly, entered into any agreement, participated in any collusion or otherwise taken any action in restraint of free competitive bidding in connection with this proposal submitted this date to the Office of Design and Development, Division of Parks and Recreation.

All the terms and conditions of the TRI-VALLEY TRAIL, PHASE II have been thoroughly examined and are understood.

NAME OF BIDDER \_\_\_\_\_

AUTHORIZED REPRESENTATIVE  
(TYPED): \_\_\_\_\_

AUTHORIZED REPRESENTATIVE  
(SIGNATURE): \_\_\_\_\_

**TITLE:** \_\_\_\_\_

ADDRESS OF BIDDER: \_\_\_\_\_  
\_\_\_\_\_  
\_\_\_\_\_

E-MAIL: \_\_\_\_\_

PHONE NUMBER: \_\_\_\_\_

Sworn to and Subscribed before me this \_\_\_\_\_ day of \_\_\_\_\_ of 20\_\_\_\_\_.

My commission expires \_\_\_\_\_ NOTARY PULIC \_\_\_\_\_

**THIS PAGE MUST BE SIGNED AND NOTORIZED FOR YOUR BID TO BE CONSIDERED.**

**HOLTS LANDING STATE PARK**  
**DIVISION OF PARKS AND RECREATION CONTRACT No. 2018-HL-200**

**AFFIDAVIT**  
**OF**  
**EMPLOYEE DRUG TESTING PROGRAM**

4104 Regulations for the Drug Testing of Contractor and Subcontractor Employees Working on Large Public Works Projects requires that Contractors and Subcontractors implement a program of mandatory drug testing for Employees who work on Large Public Works Contracts funded all or in part with public funds.

We hereby certify that we have in place or will implement during the entire term of the contract a Mandatory Drug Testing Program for our employees on the jobsite that complies with this regulation:

**Contractor/Subcontractor Name:** \_\_\_\_\_

**Contractor/Subcontractor Address:** \_\_\_\_\_  
\_\_\_\_\_  
\_\_\_\_\_

**Authorized Representative (typed or printed):** \_\_\_\_\_

**Authorized Representative (signature):** \_\_\_\_\_

**Title:** \_\_\_\_\_

Sworn to and Subscribed before me this \_\_\_\_\_ day of \_\_\_\_\_ 20\_\_\_\_.

My Commission expires \_\_\_\_\_. NOTARY PUBLIC \_\_\_\_\_.

**THIS PAGE MUST BE SIGNED AND NOTARIZED FOR YOUR BID TO BE CONSIDERED.**

(THIS PAGE INTENTIONALLY LEFT BLANK)

**Copyright 1998, The American Institute of Architects (AIA)  
SECTION 012200 - UNIT PRICES**

**PART 1 - GENERAL**

**1.1 RELATED DOCUMENTS**

- A. Drawings and general provisions of the Contract, including General and Supplementary Conditions and other Division 1 Specification Sections, apply to this Section.

**1.2 SUMMARY**

- A. This Section includes administrative and procedural requirements for unit prices.
- B. Related Sections include the following:
  - 1. Division 1 Section "Contract Modification Procedures" for procedures for submitting and handling Change Orders.
  - 2. Section 13 24 50, "Helical Screw Foundations."

**1.3 DEFINITIONS**

- A. Unit price is an amount proposed by bidders, stated on the Bid Form, as a price per unit of measurement for materials or services added to or deducted from the Contract Sum by appropriate modification, if estimated quantities of Work required by the Contract Documents are increased or decreased.

**1.4 PROCEDURES**

- A. Unit prices include all necessary material, plus cost for delivery, installation, insurance, applicable taxes, overhead, and profit.
- B. Measurement and Payment: Refer to individual Specification Sections for work that requires establishment of unit prices. Methods of measurement and payment for unit prices are specified in those Sections.
- C. Owner reserves the right to reject Contractor's measurement of work-in-place that involves use of established unit prices and to have this work measured, at Owner's expense, by an independent surveyor acceptable to Contractor.
- D. List of Unit Prices: A list of unit prices is included at the end of this Section. Specification Sections referenced in the schedule contain requirements for materials described under each unit price.

PART 2 - PRODUCTS (Not Used)

PART 3 - EXECUTION

3.1 LIST OF UNIT PRICES

- A. Unit Price No. 1 – Helical Screw Foundations.
  - 1. Description: Provide and install 8,760 linear feet of helical screw piles as shown on the Contract Plans, and as defined in Section 13 24 50, "Helical Screw Foundations."
  - 2. Unit of Measurement: Unit (~~Each~~) (Linear Feet)
- B. Unit Price No. 2 – Disposal of Excess Materials.
  - 1. Description: Remove and legally dispose of excess and/or undesirable soils, including under cut material, that can not be incorporated into the proposed construction. Price shall cover the cost of loading, hauling, and all labor, materials, and equipment necessary to remove the excess soil. Material shall be disposed of in accordance with Section 106.08 – Disposal of Unacceptable Materials, of the DelDOT Standard Specifications.
  - 2. Unit of Measurement: Unit (Cubic Yards)
- C. Unit Price No. 3 – Additional Gravel Trail.
  - 1. Description: Install 1,200 linear feet of 4-foot wide gravel trail adjacent to the existing parking lot. Trail section to match Detail C/C101. Price shall include the cost of all material, labor, equipment, hauling, and removal of excess material.
  - 2. Unit of Measurement: Unit (Lump Sum)

END OF SECTION 012700

1. THE INTENT OF THIS PROJECT IS TO PROVIDE THE FOLLOWING IMPROVEMENTS AT THE HOLTS LANDING STATE PARK:
  - 1.1. CONSTRUCTION OF 4,416 L.F. OF GRAVEL TRAIL IN PLACE OF THE EXISTING SEA HAWK TRAIL ALIGNMENT.
  - 1.2. CONSTRUCTION OF 1,304 L.F. OF NEW GRAVEL TRAIL TO RELOCATE PORTIONS OF THE EXISTING SEA HAWK TRAIL.
  - 1.3. CONSTRUCTION OF 629 L.F. OF NEW GRAVEL TRAIL ALONG THE SOUTHERN EDGE OF THE EXISTING PARKING LOT.
  - 1.3. CONSTRUCTION OF ONE (1) 600' LONG BOARDWALK.
  - 1.4. CONSTRUCTION OF ONE (1) 60' LONG BOARDWALK.

- ## GENERAL NOTES

15. THE CONTRACTOR SHALL CONTACT MISS UTILITY TWO (2) CONSECUTIVE WORKING DAYS PRIOR TO EXCAVATION, OR AS REQUIRED BY LAW, AT 1-800-282-8555.



1. CLEAR AND GRUB TREES & VEGETATION WITHIN TRAIL LOD (8 FT WIDE)
  - A. DNREC TO MARK TREES TO REMAIN PRIOR TO DEMOLITION.
  - B. TREES TO BE REMOVED OUTSIDE OF THE TRAIL SHOULDERS SHALL BE CUT FLUSH WITH EXISTING GRADE WITHOUT THE REMOVAL OF STUMPS.
2. SUBGRADE SHALL BE LEVELED WITH A GRADER OR OTHER SUITABLE SCRAPER BLADE, AND PROOF ROLLED VIA MINIMUM TWO PASSES WITH A WALK BEHIND, DOUBLE DRUM ROLLER - VIBRATORY COMPACTOR.
3. SURFACE COURSE (DELAWARE #10 STONE) SHALL BE COMPACTED WITH A MINIMUM OF 4 PASSES OF A TWO DRUM VIBRATORY ROLLER WEIGHING AT LEAST 2500 LBS.



1. CLEAR AND GRUB TREES & VEGETATION WITHIN TRAIL LOD (8 FT WIDE)
  - A. DNR/EC TO MARK TREES TO REMAIN PRIOR TO DEMOLITION.
  - B. TREES TO BE REMOVED OUTSIDE OF THE TRAIL. SHOULDERS SHALL BE CUT FLUSH WITH EXISTING GRADE WITHOUT THE REMOVAL OF STUMPS.
2. SUBGRADE SHALL BE LEVELED WITH A GRADER OR OTHER SUITABLE SCRAPER BLADE, AND PROOF ROLLED VIA MINIMUM TWO PASSES WITH A WALK BEHIND, DOUBLE DRUM ROLLER - VIBRATORY COMPACTOR.
3. SURFACE COURSE (DELAWARE #10 STONE) SHALL BE COMPACTED WITH A MINIMUM OF 4 PASSES OF A TWO DRUM VIBRATORY ROLLER WEIGHING AT LEAST 2500 LBS.



1. SIDEWALK TO BE CONSTRUCTED FLUSH WITH EXISTING GRADE.
2. SUBGRADE SHALL BE LEVELED WITH A GRADER OR OTHER SUITABLE SCRAPER BLADE, AND PROOF ROLLED VIA MINIMUM TWO PASSES WITH A WALK BEHIND, DOUBLE DRUM ROLLER - VIBRATORY COMPACTOR.
3. SURFACE COURSE (DELAWARE #10 STONE) SHALL BE COMPACTED WITH A MINIMUM OF 4 PASSES OF A TWO DRUM VIBRATORY ROLLER WEIGHING AT LEAST 2500 LBS.

## LEGEND

	PARCEL LINE	N/A
	FLOODPLAIN	N/A
	CONTOUR	N/A
	TREELINE	N/A
	WETLAND BOUNDARY	N/A
	DITCH	N/A
	POND	N/A
	SIGN	
	BUILDING/PAVILION	N/A
	GRAVEL TRAIL	
	TRAIL TO BE REMOVED	
	BOARDWALK	
	LIMIT OF DISTURBANCE	LOD
	LIMIT OF CONSTRUCTION	LOC
	SILT FENCE	SF

COUNTY TAX MAP: 134-3.00-6.00  
134-4.00-1.00

2. DNREC PROJECT NUMBER: \_\_\_\_\_

3. ADDRESS OF SITE: HOLTS LANDING STATE PARK, HOLTS LANDING ROAD  
DAGSBORO, DE 19939

4. SITE COORDINATES AT CENTER OF PROJECT SITE: LATITUDE: 38.5899 N  
LONGITUDE: -75.1302 W

5. ZONING: EXISTING: ST  
PROPOSED: ST

LOT AREA: TAX PARCEL NO. EXISTING PROPOSED  
134-3.00-6.00 111.86 AC 111.86 AC  
134-4.00-1.00 59.44 AC 59.44 AC

SOURCE OF TITLE: TAX PARCEL NO. DEED RECORD/INSTRUMENT NUMBER  
134-3.00-6.00 \_\_\_\_\_  
134-4.00-1.00 \_\_\_\_\_

6. EXISTING USE: STATE PARK

7. PROPOSED USE: STATE PARK

8. DATUM: EXISTING  
VERTICAL - NAVD 88  
HORIZONTAL - NAD 83

9. SITE CONDITIONS WITHIN LIMITS OF DISTURBANCE (ACRES)

EXISTING CONDITIONS		PROPOSED CONDITIONS	
TRAIL	0.41 ACRES	TRAIL	0.59 ACRES
FOREST	0.57 ACRES	FOREST	0.44 ACRES
OPEN SPACE	0.20 ACRES	OPEN SPACE	0.15 ACRES
TOTAL	1.18 ACRES	TOTAL	1.18 ACRES

IMPERVIOUS CONDITIONS  
EXISTING 35% PROPOSED 50%

10. FLOOD PLAN MAP  
PER FIRM MAP NUMBER 10005C0484K, DATED MARCH 16, 2015, THIS SITE LIES WITHIN ZONE AE.  
A 100 YEAR FLOODPLAIN HAS BEEN CALCULATED AND THE BASE FLOOD ELEVATION (BFE) VARIES FROM 6 TO 8.

11. WATER RESOURCES PROTECTION  
\_\_\_\_\_

12. TOTAL LAND DISTURBANCE  
THE TOTAL LAND DISTURBANCE PROPOSED BY THIS PLAN IS 1.18± ACRES (50,792± S.F.)

13. LIMITS OF CONSTRUCTION  
THE TOTAL LIMITS OF CONSTRUCTION FOR THE SITE IS 1.32± ACRES (57,392± S.F.)

14. LENGTH OF PROPOSED TRAIL: 6,349 FT. (1.20 MILES).

15. LENGTH OF PROPOSED BOARDWALK: 660 FT. (0.125 MILES)

16. WETLANDS  
THE TOTAL WETLANDS EXISTING WITHIN THE LIMITS OF DISTURBANCE IS 0± ACRES (0± S.F.)

17. OWNER/DEVELOPER: STATE OF DELAWARE  
DNREC, DIVISION OF PARKS & RECREATION  
89 KINGS HIGHWAY, DOVER, DE 19901  
PHONE: 302-739-9210  
FAX: 302-739-3817

18. CIVIL ENGINEER: CENTURY ENGINEERING, INC.  
4134 NORTH DUPONT HIGHWAY, DOVER, DE 19901  
WALTER J. HOEY III, P.E.  
PHONE: (302) 734-9188  
FAX: (302) 734-4589

①	ITEM 301001 - GRADED AGGREGATE BASE COURSE, TYPE B	DEPTH: 4" - EXISTING TRAILS, 6" - RELOCATED/NEW TRAILS
②	ITEM 302004 - DELAWARE NO. 10 STONE	
③	ITEM 708002 - SEPARATION GEOTEXTILE [TO BE NON-WOVEN SEPARATION FABRIC (ASPHIT M 288, CLASS 2 - Miraf 140n, OR EQUIVALENT) BETWEEN PREPARED SUBGRADE AND GABC BASE COURSE.]	
④	ITEM 905001 - SILT FENCE OR COMPOST FILTER LOG(W/IN. 18") [REFER TO SHEET SSP500 FOR INSTALLATION REQUIREMENTS AND ADDITIONAL EROSION AND SEDIMENT CONTROL NOTES.]	

ITEM NUMBERS UTILIZE THE CURRENT 2016 DELDOT STANDARD SPECIFICATIONS. ITEM NUMBERS THAT HAVE A "0" FOR THE FOURTH DIGIT, REFER TO DELDOT "STANDARD SPECIFICATIONS". IT IS THE CONTRACTOR'S RESPONSIBILITY TO OBTAIN THE DELDOT STANDARD SPECIFICATIONS EITHER ONLINE OR HARD COPY FROM DELDOT TO REFERENCE THESE ITEMS.

**REVISIONS:**

DATE: DESCRIPTION:

BY:

REVISÉD TRAIL WIDTH, DETAILS A, B, AND C.

REVISÉD TRAIL WIDTH, DETAILS A, B, AND C.

## HOLTS LANDING BOARDWALK & TRAIL IMPROVEMENTS

## PROJECT NOTES & LEGEND

SEAL



CIVIL ENGINEER

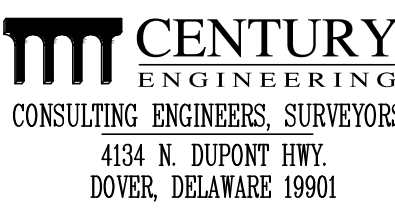

CEI CONTRACT NO.: 125002.25

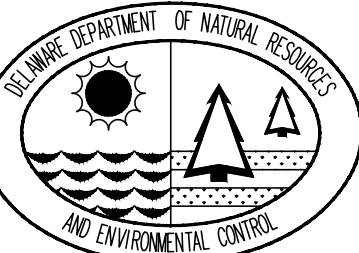

DESIGNED BY:

WJH

DRAWN BY:

DFS

CHECKED BY:

## AES

DATE \_\_\_\_\_

SEPTEMBER 2018

SCALE:

NONE

SHEET NO.:

C301

CONTRACT NO.:

2018-HL-200



C:\PRODUCTS\17501.00 (DWG: 2017 Engineering: CE\17501.07 (Holt's Landing Boardwalk Definition & Permitting)\CADD FILES\Sheet\C306 - Signing & Striping Plan.dwg, 2/12/2019 1:14 PM

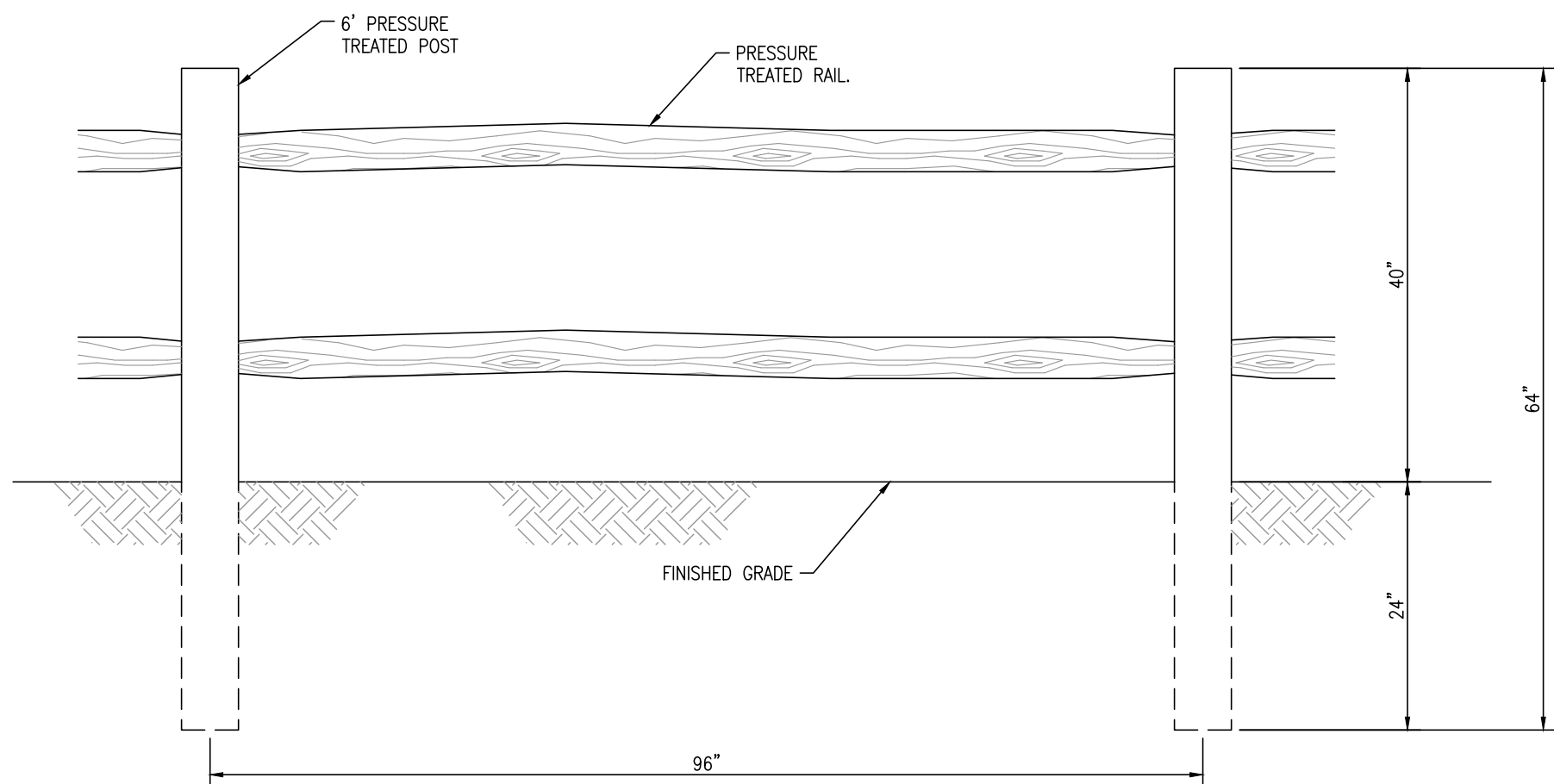

1  
C306 SPLIT RAIL FENCE DETAIL (ADD ALTERNATE #1)  
NTS

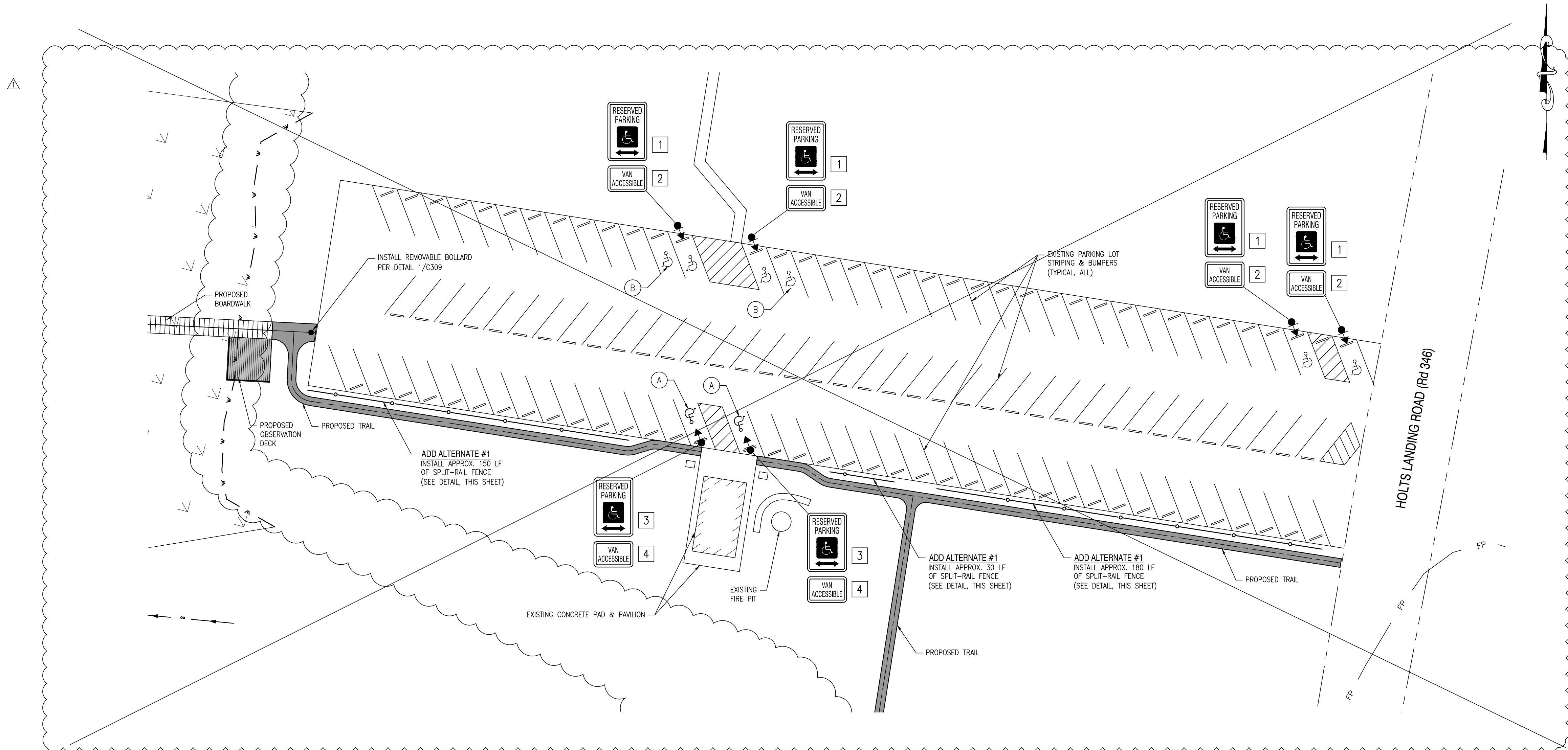

#### NOTES:

- EXISTING PARKING LOT STRIPING & PARKING BUMPERS TO REMAIN UNLESS OTHERWISE NOTED.
- CONTRACTOR TO VERIFY LOCATION OF EXISTING UTILITIES. PROPOSED SIGNS TO BE PLACED WITH REQUIRED CLEARANCE FROM ALL UTILITIES.

PAVEMENT MARKINGS LEGEND	
SYMBOL	ITEM
(A)	BLUE LATEX HANDICAP SYMBOL
(B)	REMOVE EXISTING SYMBOL PAINT, OR MASK/PAINT OVER WITH GRAY PAINT

#### SIGN SCHEDULE:

#	SHEET NO.	PLAN INDICATOR	CODE	QTY.	DESCRIPTION	SIGN WIDTH (IN)	SIGN HEIGHT (IN)	SIGN AREA (SF)	ITEM 819018 SINGLE POST (EACH)			ITEM 819019 MULTIPOST (SF)			POST INSTALLATION TYPE
									SIGN DISPOSITION	REMOVE	INSTALL	SIGN DISPOSITION	REMOVE	INSTALL	
428	C308	1	R7-8	4	RESERVED PARKING (Disabilities - symbols)	12"	18"	1.5	NEW						SOIL
429	C308	2	R7-8P	4	VAN ACCESSIBLE (plaque)	12"	6"	0.5	NEW						SOIL
428	C308	3	R7-8	2	RESERVED PARKING (Disabilities - symbols)	12"	18"	1.5	NEW						HOTMIX
429	C308	4	R7-8P	2	VAN ACCESSIBLE (plaque)	12"	6"	0.5	NEW						HOTMIX

#### NOTE:

- SIGNS 3&4 TO BE INSTALLED IN PAVEMENT ON 2" SQUARE METAL TUBING
- DESIGN, FABRICATION AND INSTALLATION OF ALL PERMANENT SIGNING SHALL COMPLY WITH THE LATEST EDITION OF THE DELAWARE MUTCD. (SPECIFIC REQUIREMENTS OUTLINED UNDER PART 9 - TRAFFIC CONTROLS FOR BICYCLE FACILITIES.)

2  
C306 STEEL SIGN POST DETAIL  
NTS

#### NOTE:

- SIGNS 1&2 TO BE INSTALLED IN EARTH ON 4"x4" SOUTHERN YELLOW PINE PRESSURE TREATED POST, ACQ 0.4 PCF.
- DESIGN, FABRICATION AND INSTALLATION OF ALL PERMANENT SIGNING SHALL COMPLY WITH THE LATEST EDITION OF THE DELAWARE MUTCD. (SPECIFIC REQUIREMENTS OUTLINED UNDER PART 9 - TRAFFIC CONTROLS FOR BICYCLE FACILITIES.)

3  
C306 TIMBER SIGN POST DETAIL  
NTS



#### REVISIONS:

DATE: 2/12/2019  
DESCRIPTION: [REDACTED]

HOLTS LANDING BOARDWALK & TRAIL IMPROVEMENTS

SIGNING & STRIPING PLAN

#### SEAL:



#### CIVIL ENGINEER:

**CENTURY**  
ENGINEERING  
CONSULTING ENGINEERS, SURVEYORS  
4134 N. DUPONT HWY.  
DOVER, DELAWARE 19901

CEI CONTRACT NO.: 125002.25

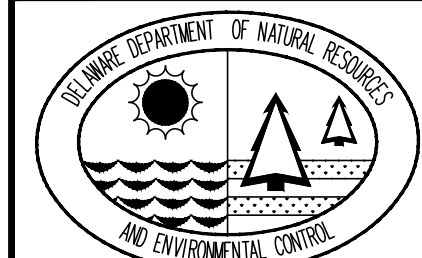

#### DESIGNED BY:

WJH

#### DRAWN BY:

DFS

#### CHECKED BY:

AES

#### DATE:

SEPTEMBER 2018

#### SCALE:

1" = 30'

#### SHEET NO.:

C306

#### CONTRACT NO.:

2018-HL-200



