



ALUMNI STADIUM

NCAA TRACK AND FIELD SURFACING REPLACEMENT

PROJECT # PC-18-006

ISSUED FOR BID
FEBRUARY 22, 2018



DELAWARE STATE UNIVERSITY
ALUMNI STADIUM
PC-18-006 - NCAA TRACK AND FIELD
SURFACING REPLACEMENT
1200 N. DUPONT HIGHWAY
DOVER, DELAWARE 19901

COVER SHEET

DATE: February 22, 2018

SCALE: VARIES

SHEET:

G.1

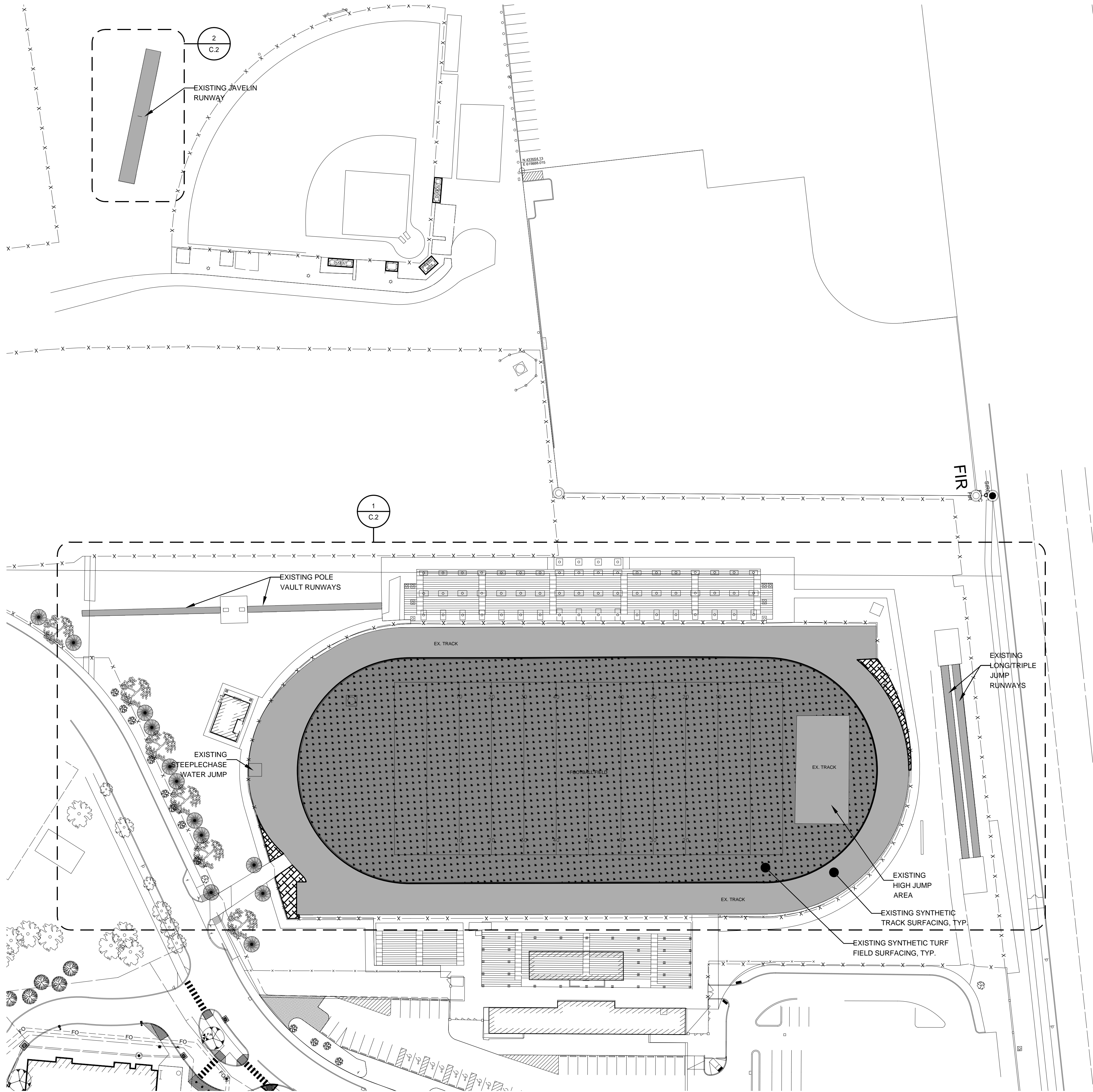

SITE PLAN

GENERAL NOTES

1. ALL SEDIMENT AND EROSION CONTROL FACILITIES SHALL CONFORM TO THE DELAWARE EROSION AND SEDIMENT CONTROL HANDBOOK, CURRENT EDITION.
2. ALL PRE-CONSTRUCTION CONDITIONS WITHIN THE PROJECT LIMITS SHALL BE RESTORED TO PRE-CONSTRUCTION CONDITIONS PRIOR TO SUBSTANTIAL COMPLETION .
3. THIS DRAWING DOES NOT INCLUDE NECESSARY COMPONENTS FOR CONSTRUCTION SAFETY. ALL CONSTRUCTION MUST BE EXECUTED IN COMPLIANCE WITH THE OCCUPATIONAL SAFETY AND HEALTH ACT OF 1970 AND ALL RULES AND REGULATIONS THERETO APPURTENANT.
4. THE CONTRACTOR SHALL MAKE EVERY EFFORT TO PROTECT ALL EXISTING LANDSCAPING, INCLUDING BUT NOT LIMITED TO TREES, SHRUBS, GROUNDCOVER, ETC.. SHOULD SUCH SITE FEATURES BE DAMAGED OR DESTROYED DUE TO THE CONTRACTOR'S NEGLIGENCE, THE CONTRACTOR SHALL BEAR THE COST AND RESPONSIBILITY FOR REPAIR, REPLACEMENT, AND/OR INSTALLATION OF DAMAGED ITEM(S).
5. ALL BACKFILL MATERIALS AND COMPACTION REQUIREMENTS SHALL BE IN ACCORDANCE WITH APPLICABLE DELDOT STANDARDS, UNLESS OTHERWISE STATED ON THIS PLAN.
6. EXISTING SITE LOCATIONS AND BOUNDARY LINES TAKEN FROM AERIAL MAPPING DATED 2016.
7. IT SHALL BE THE CONTRACTORS RESPONSIBILITY TO PROPERLY PREPARE EXISTING SURFACES PRIOR TO PERFORMING WORK INDICATED HEREIN. THIS WORK SHALL INCLUDE, BUT MAY NOT BE LIMITED TO SWEEPING, VEGETATION REMOVAL, AND DEBRIS REMOVAL.
8. PRIOR TO SUBMITTING BID THE CONTRACTOR SHALL VISIT THE SITE AND BE THOROUGHLY FAMILIAR WITH THE EXISTING CONDITIONS AND PROPOSED CONSTRUCTION. CONTRACTOR SHALL INCLUDE IN THE BID ALL MATERIAL, LABOR, AND ALL INCIDENTALS FOR A COMPLETE INSTALLATION WHETHER SPECIFICALLY INDICATED OR NOT. ALL ERRORS AND OMISSIONS SHALL BE BROUGHT TO THE ATTENTION OF THE OWNER DURING THE BIDDING PROCESS BY THE CONTRACTOR. THESE ITEMS SHALL BE INCLUDED IN THE BID PRICES. NO COMPENSATION WILL BE CONSIDERED OF ANY DISCREPANCY WHICH COULD HAVE BEEN NOTICED AT THE SITE VISIT BY THE CONTRACTOR.

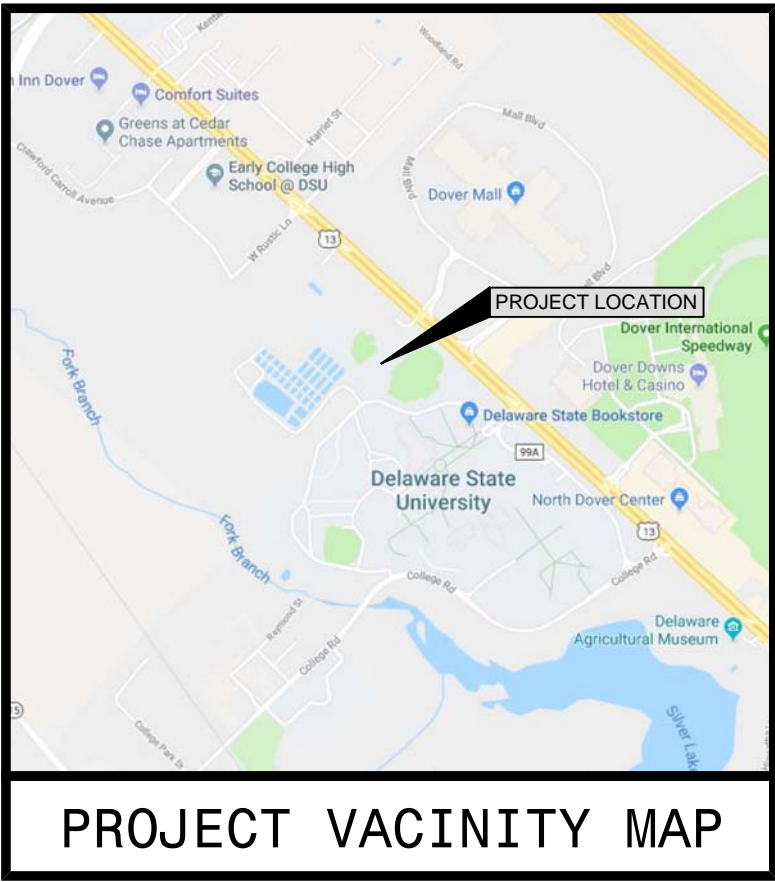

DELAWARE STATE UNIVERSITY
ALUMNI STADIUM
PC-18-006 - NCAA TRACK AND FIELD
SURFACING REPLACEMENT
1200 N. DUPONT HIGHWAY
DOVER, DELAWARE 19901

OVERALL SITE
PLAN

DATE: February 22, 2018

SCALE: 1" : 50'

SHEET:

C.1

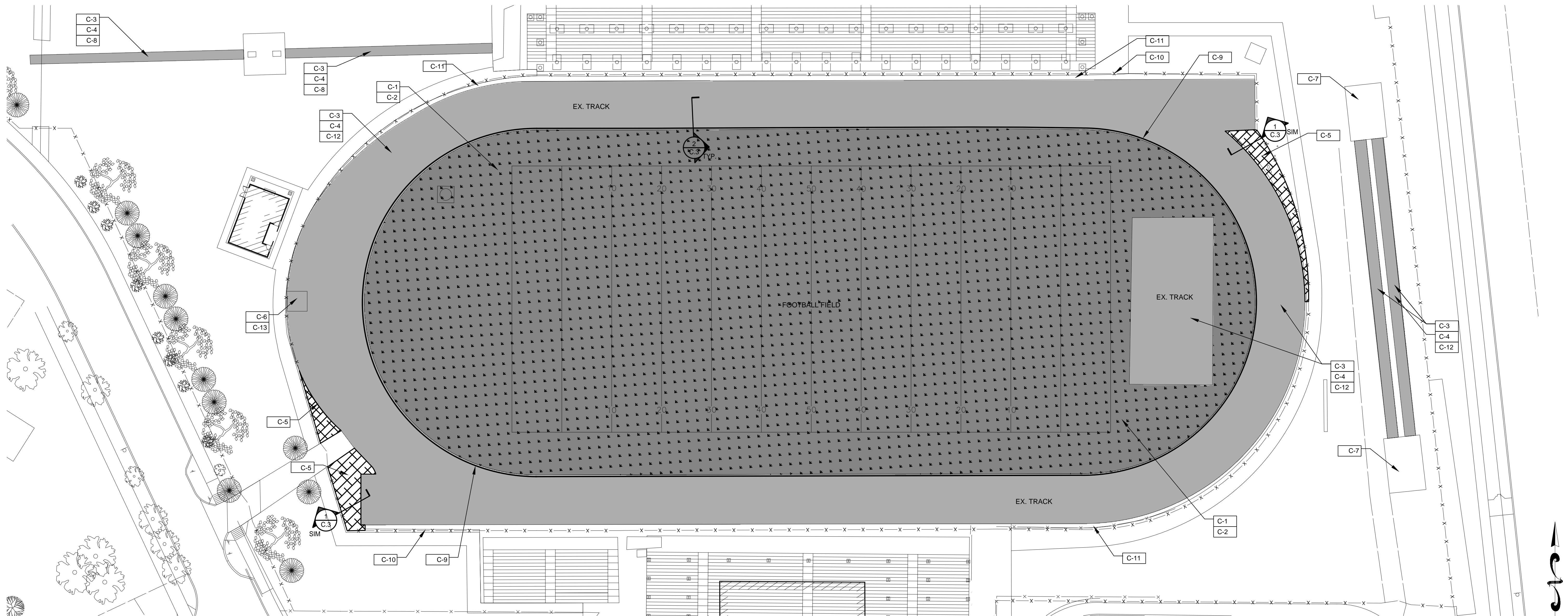

1
C.2
ENLARGED PARTIAL PLAN
SCALE: 1" = 30'

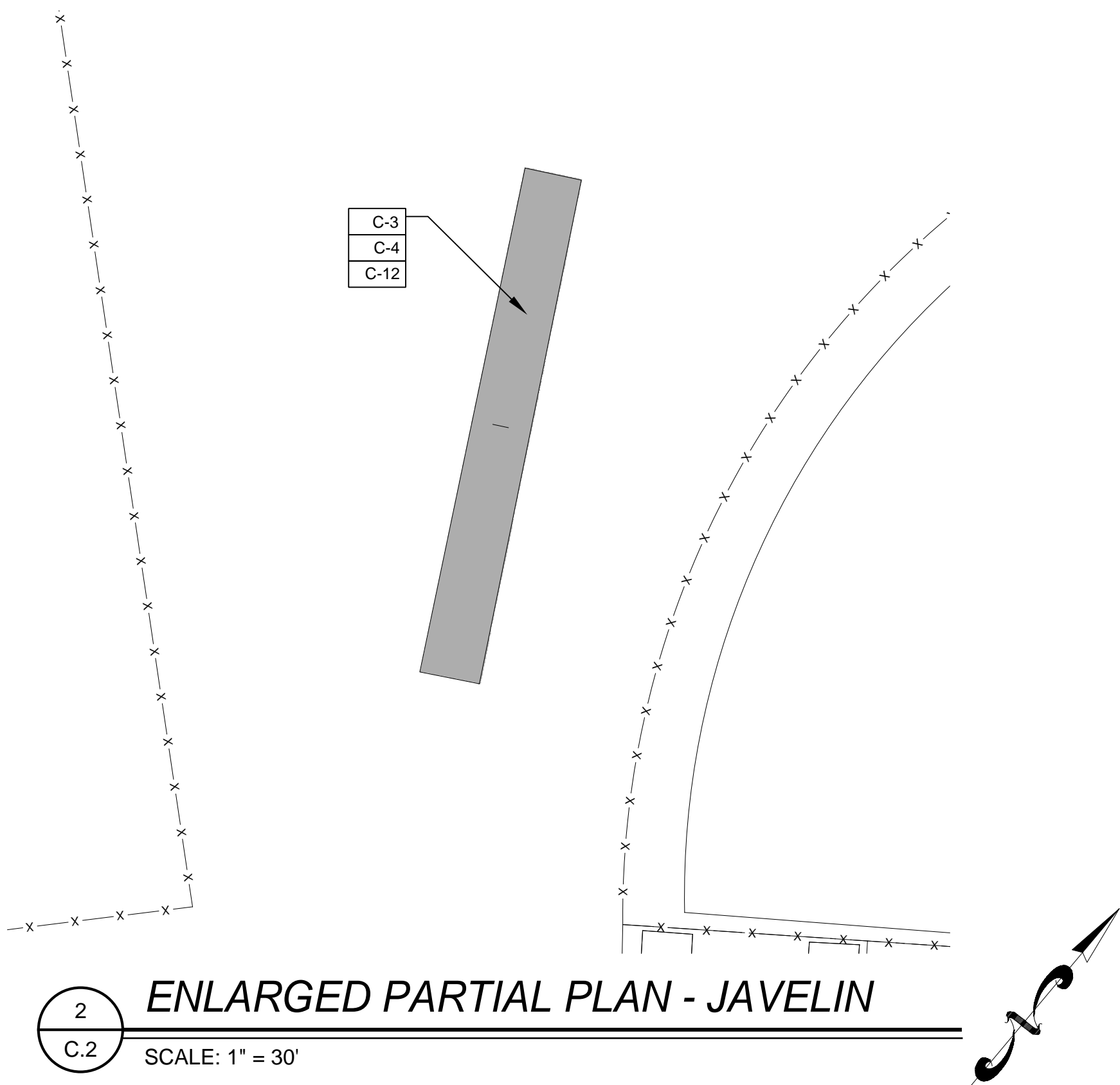

2
C.2
ENLARGED PARTIAL PLAN - JAVELIN
SCALE: 1" = 30'

KEY NOTES

- C-1 BASE BID PACKAGE 'A' - REMOVE AND DISPOSE OF EXISTING TURF FIELD SURFACING AND ALL RUBBER/ORGANIC INFILL. THE UNIVERSITY WILL IDENTIFY 3,000 SQUARE FEET OF EXISTING SURFACING REMNANTS AND INFILL THAT SHALL BE RETAINED AND RELOCATED BY THE CONTRACTOR. CONTRACTOR SHALL COORDINATE AND DELIVER REMNANTS TO THE DSU SPORTS ANNEX, 255 COLLEGE ROAD, DOVER, DELAWARE 19901.
- C-2 BASE BID PACKAGE 'A' - AFTER REMOVAL OF THE EXISTING SYNTHETIC TURF FIELD SURFACING THE CONTRACTOR SHALL PREPARE THE FIELD IN ACCORDANCE IN THE SPECIFICATIONS. PREPARE EXISTING STONE DRAINAGE BASE WITH LOCALIZED REGRADING AS NECESSARY TO MEET SYNTHETIC FIELD MANUFACTURER'S REQUIREMENTS. REFER TO SPECIFICATIONS FOR APPLICABLE BID ALLOWANCE. ONCE SUB GRADE CONDITIONS ADHERE WITH THE MANUFACTURERS INSTALLATION INSTRUCTIONS, SYNTHETIC TURF SYSTEM SHALL BE INSTALLED. CHEMICALLY BOND SYTHETIC TURF SYSTEM TO EXISTING CONCRETE CURB. SEE DETAIL 2/C.3.
- C-3 BASE BID PACKAGE 'B' - REMOVE AND DISPOSE OF EXISTING SYNTHETIC TRACK SYSTEM TO EXPOSE EXISTING ASPHALT PAVEMENT.
- C-4 BASE BID PACKAGE 'B' - PRESSURE WASH AND PREPARE EXISTING ASPHALT PAVEMENT SURFACE AND INSTALL NEW SYNTHETIC TRACK SURFACING SYSTEM IN ACCORDANCE WITH THE SPECIFICATIONS.
- C-5 BID ALTERNATE #B1 - CLEAR, GRUB, AND STRIP EXISTING VEGETATION AND INSTALL NEW WARM-MIX ASPHALT (WMA) PAVING SURFACE. SEE DETAIL 1/C.3.
- C-6 BID ALTERNATE #B2 - INSTALL 18" DIAMETER, 22-GALLON, POLYETHYLENE SUMP BASIN WITH INTERLOCKING LID IN EXISTING STEEPLECHASE WATER JUMP PIT.
- C-7 BASE BID PACKAGE 'B' - CLEAR EXISTING VEGETATION AND CONDUCT LOCALIZED REGRADING TO REESTABLISH EXISTING SAND PIT. SEED AND MULCH AS NECESSARY TO STABILIZE.
- C-8 BASE BID PACKAGE 'B' - CLEAR EXISTING VEGETATION, CONDUCT LOCALIZED REGRADING, MILL 1 1/2" AND OVERLAY 1 1/2" WARM-MIX ASPHALT (WMA) OVER EXISTING ASPHALT PAVEMENT RUNWAY.
- C-9 BASE BID PACKAGE 'B' - FURNISH AND INSTALL REMOVABLE 2" NCAA COMPLIANT ALUMINUM TRACK CURB.
- C-10 BID ALTERNATE #B4 - COMPLETE MISCELLANEOUS REPAIRS TO EXISTING CHAIN LINK FENCING AS DIRECTED BY OWNER. REFER TO SPECIFICATIONS FOR APPLICABLE BID ALLOWANCE.
- C-11 BID ALTERNATE #B5 - APPLY BITUMINOUS SURFACE TREATMENT TO EXISTING ASPHALT PAVEMENT BETWEEN SYNTHETIC TRACK AND PERIMETER FENCING.
- C-12 BASE BID PACKAGE 'B' - REPAIR EXISTING ASPHALT PAVING AS DIRECTED BY OWNER. REFER TO SPECIFICATIONS FOR APPLICABLE BID ALLOWANCE.
- C-13 BID ALTERNATE #B3 - FURNISH AND INSTALL NEW FLUSH STEEPLECHASE WATER JUMP COVER.

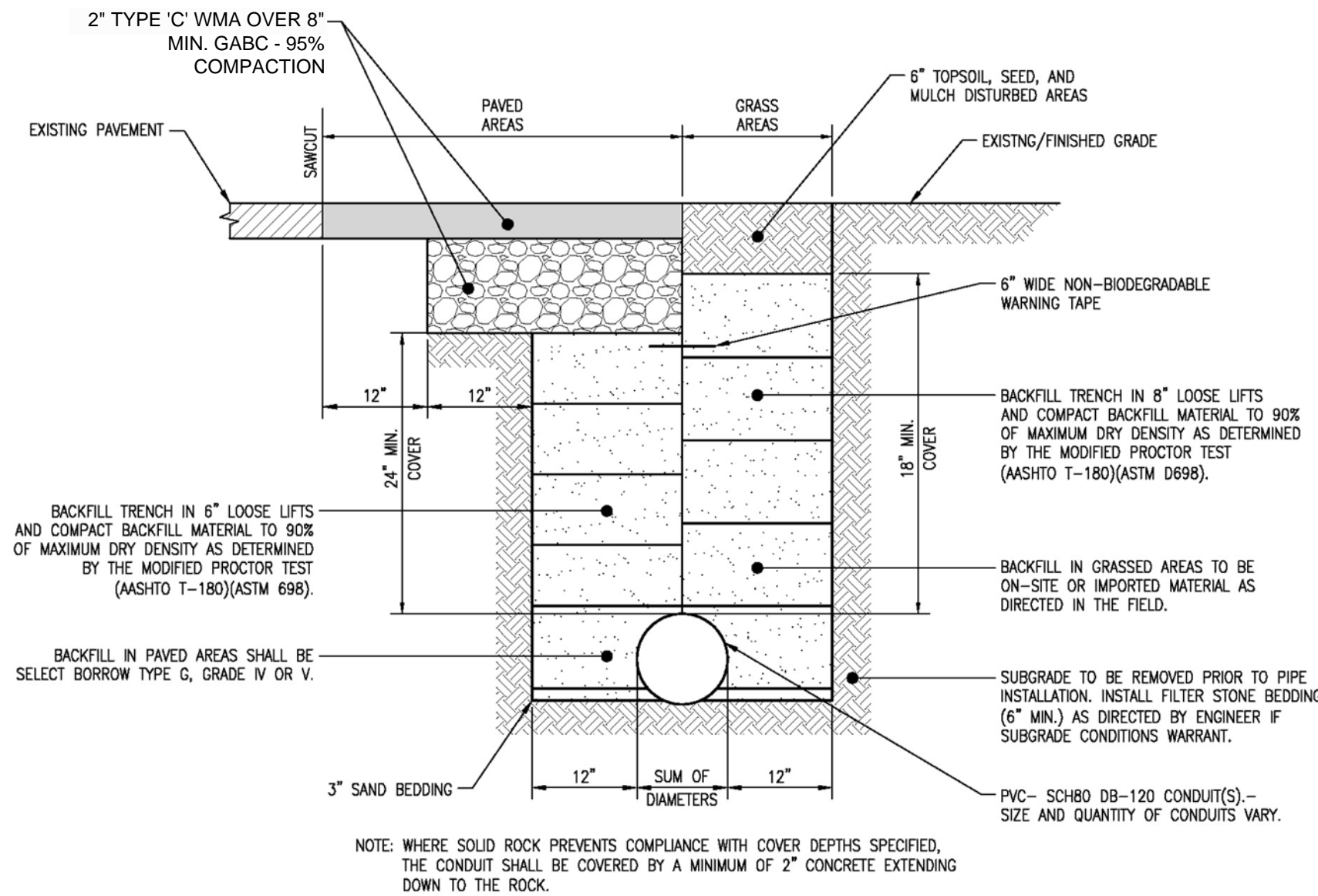

1

C.3

TYPICAL PAVEMENT SECTION

SCALE: NTS

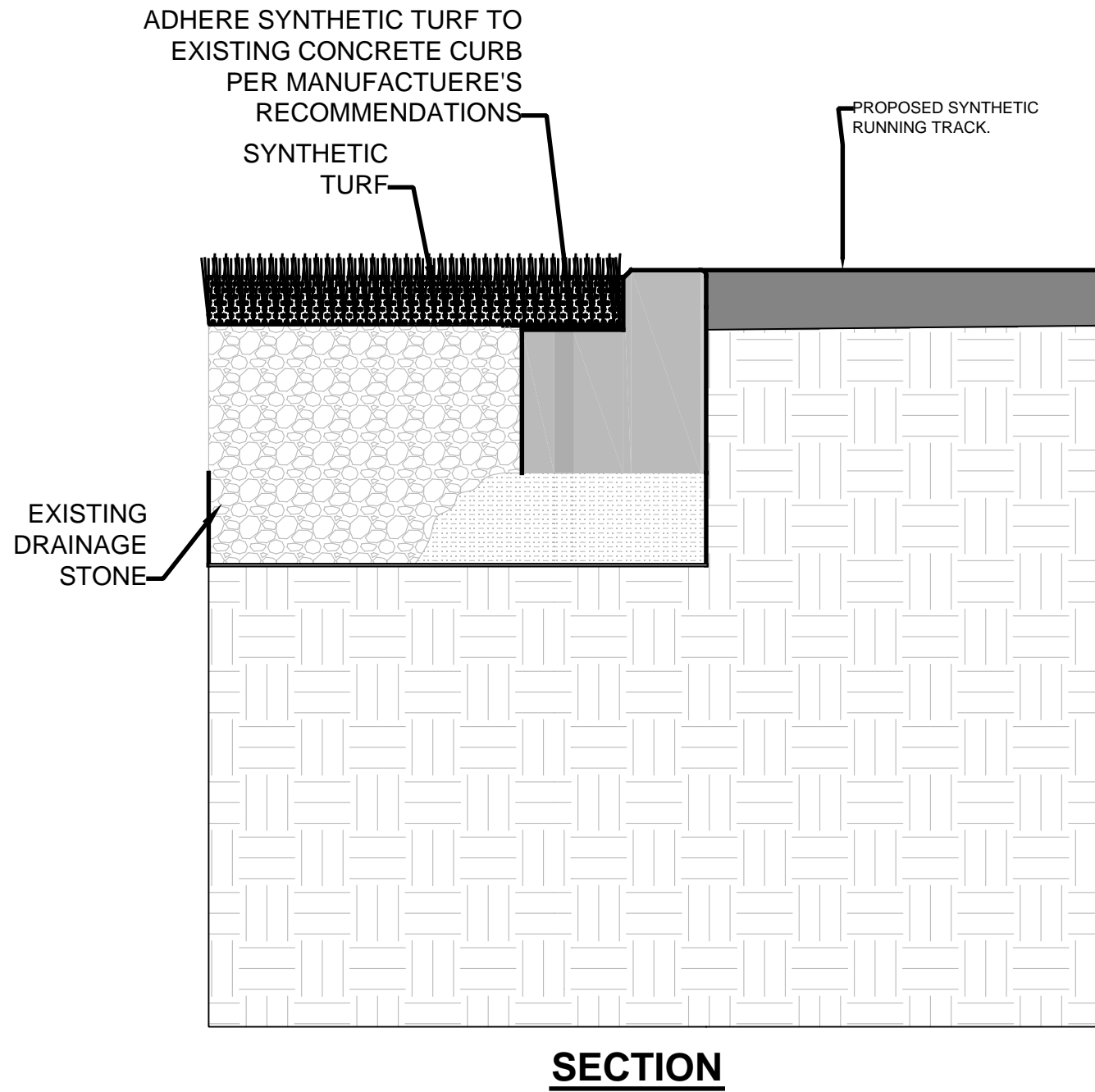

2

C.3

TURF FINISH AT CONCRETE CURB

SCALE: NTS