



STATE OF DELAWARE  
**DEPARTMENT OF TRANSPORTATION**  
800 BAY ROAD  
P.O. Box 778  
DOVER, DELAWARE 19903

SHAILEN P. BHATT  
SECRETARY

February 11, 2013

Ladies and Gentlemen:

Attached is **Addendum No. 3** for Request for Proposal 1601- E-Z Pass Customer Service Center/DMV Telephone Call Center indicating the following revisions:

1. The Building Floor Plan for the E-Z Pass Customer Service Center/DMV Call Center to be located at 22-24 Loockerman Street, Dover, DE is being added to the RFP as ATTACHMENT F.
2. To further clarify Section 4.1 the required generator/back-up power supply system costs are the responsibility of the vendor.
3. The successful bidder will be responsible for designing and installing security systems (i.e. cameras).
4. Bidders must use the attached REVISED cost proposal page which includes the monthly lease/rental fees for the property at 22-24 Loockerman Street, Dover DE. The amount shown is the estimated **one-year lease/rental** fee for the included floor plan. This amount is the fee for the building plan "as is" and does not include any vendor requested build-out, utilities, or content insurance. All changes to building configuration must be pre-approved by the Department.
5. Vendors should use the dollar figure shown on the revised cost proposal page when determining other costs; therefore, do not include the identified lease/rental cost in your other proposed cost.

Please review this information prior to submitting your response to our Request for Proposals.

Regards,

A handwritten signature in blue ink that reads "Wendy B. Henry".

Wendy B. Henry, CPPB  
Consultant Control Coordinator  
DelDOT Contract Administration  
(302) 760-2531

**Addendum No. 3**  
**February 11, 2013**

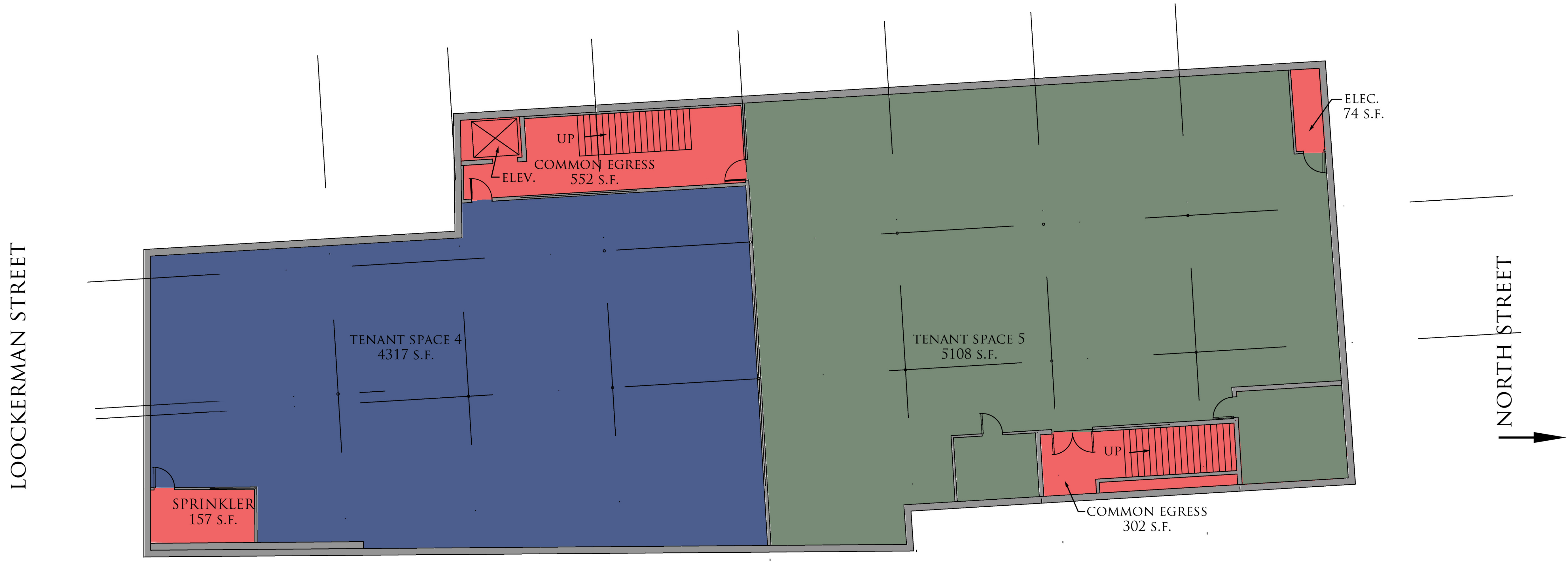

1ST FLOOR - 11282 S.F.  
 BASEMENT - 10519 S.F.  
 TOTAL - 21801 S.F.

